

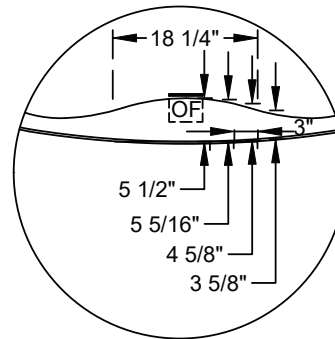

Designer Collection Specifications

AD553

MicroSilk[®] - AirMasseur[®]

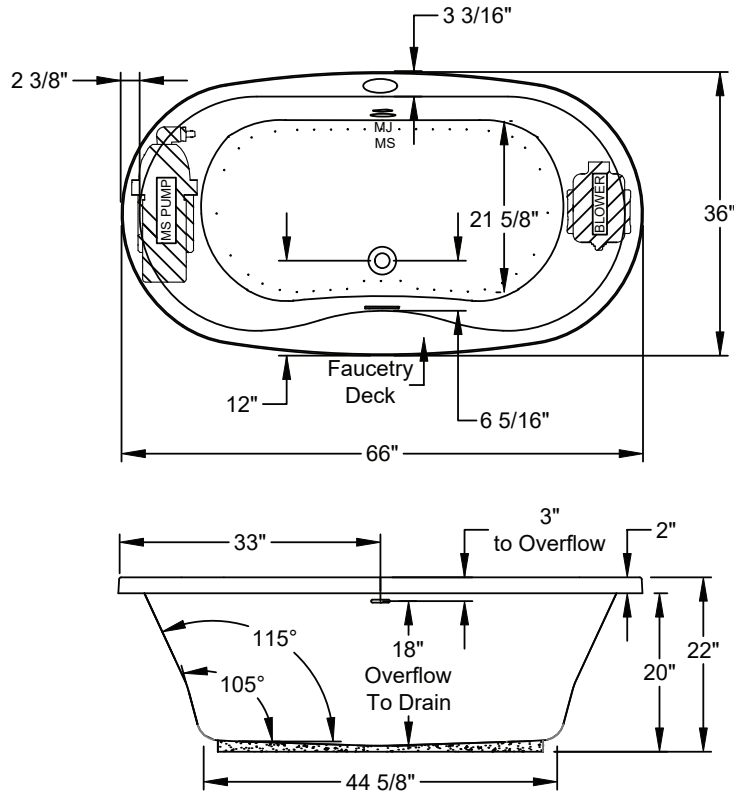

Faucetry Deck
Flat Dimensions

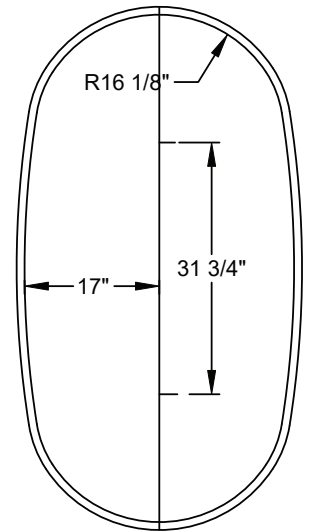

Drop In Hole Size

Note: The blower extends approximately 1" past the end radius of the bath. This requires angling the bath into the drop-in hole.

Patents received or pending.



Includes Linear Overflow Drain Assembly

Note: Dimensional Tolerances: $\pm 1/4"$

- Drop-in Hole Size:** See Diagram
- Operating Capacity:** 41 Gal.
- Overflow Capacity:** 84 Gal.
- Floor Loading / sq.ft.:** 54 lbs.
- Carton Wt.:** 156 lbs.
- Cube:** 36.6 ft.³

Construction: Fiberglass reinforced acrylic bath with Level Form[™] full-support base.

We provide products listed with Intertek ETL SEMKO (Edison Testing Laboratories) U.S. and Canadian and with International Association of Plumbing and Mechanical Officials (IAPMO). Consult factory with your listing requirements.

Standard	 <p>A 120V system that includes a MicroSilk[®] unit; a 1HP, variable speed air blower with integral air heater; automatic purge cycle; an electronic control that operated the MicroSilk[®] unit, blower, and blower speed for continuous, pulse or wave massage modes; and a 20-minute timer.</p>
Premier	 <p>A 120V system that includes a MicroSilk[®] unit; a 1HP, variable speed air blower with integral air heater; automatic purge cycle; (2) Chromatherapy mood lights; Automatic Ozone System; a digital control with LCD display that operates the MicroSilk[®] Unit, blower and blower speed for continuous, pulse or wave massage modes; enhanced user control options; and a 20-minute timer. Control keypad operates the MicroSilk[®] unit, blower and blower speed for continuous, pulse or wave massage modes, LED Chromatherapy lights and shows MicroSilk[®] status, blower speed, and time remaining.</p>