

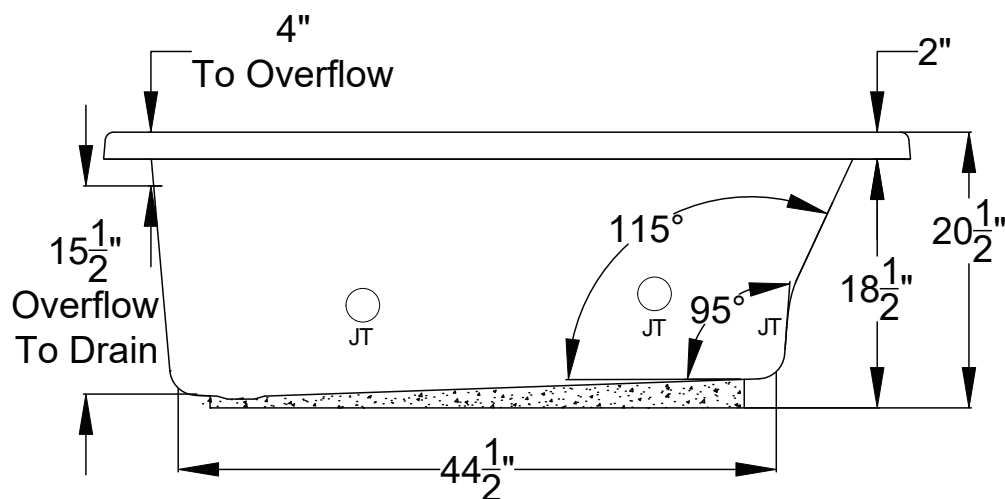

## Integrity® Collection Specifications

# K3060

## Whirlpool & Soaking

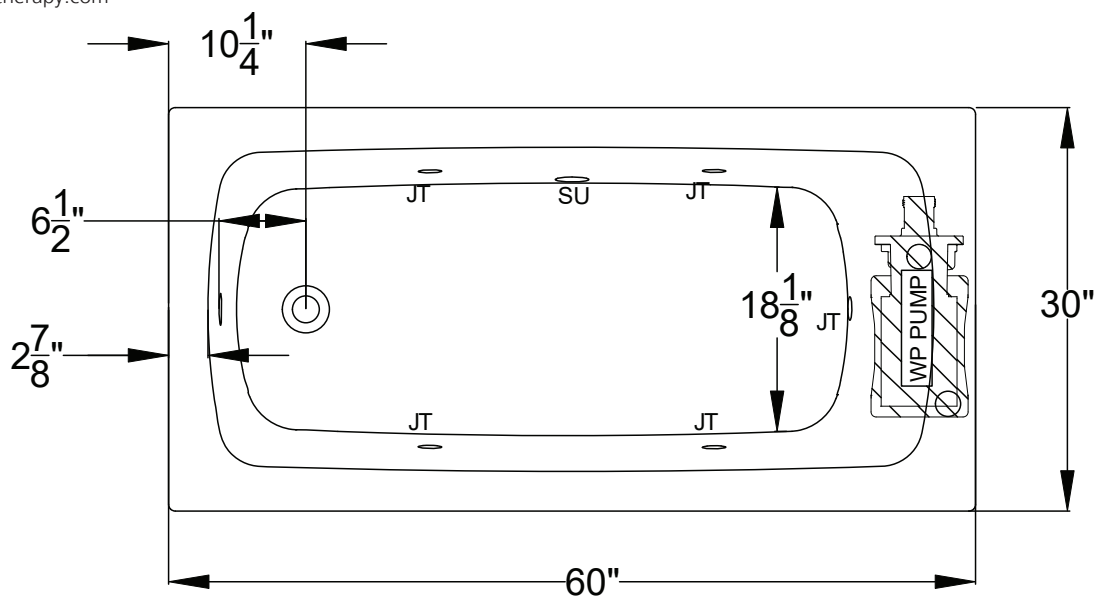

Patents received or pending.

Note: Dimensional Tolerances: +1/4"

**Drop-in Hole Size:** 28" x 58"

**Operating Capacity:** 38 Gal.

**Overflow Capacity:** 60 Gal.

**Floor Loading / sq.ft. (WP/Soaking):** 56.8 / 53.3 lbs.

**Carton Wt. (WP/Soaking):** 101 / 66 lbs.

**Cube:** 26.4 ft.<sup>3</sup>

## Air Switch Control

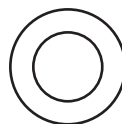

Includes a quiet, 120v, 1HP, 1-speed pump and an air switch on/off control. Requires (1) 20A, 120v GFCI protected circuit.

**Construction:** Reinforced Acrylic shell mounted on Level Form™ pre-leveled full support base.

*We provide products listed with Intertek ETL SEMKO (Edison Testing Laboratories) U.S. and Canadian and with International Association of Plumbing and Mechanical Officials (IAPMO). Consult factory with your listing requirements.*