

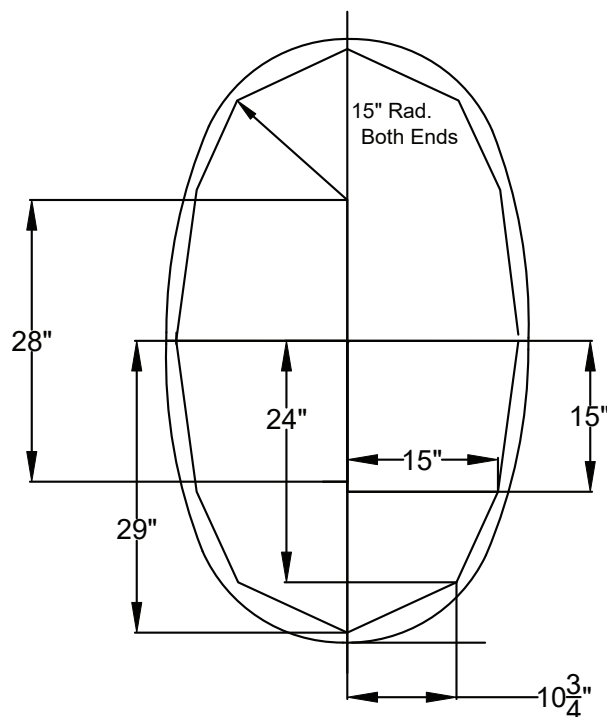

## Integrity<sup>®</sup> Collection Specifications

### N3660

### MicroSilk<sup>®</sup>

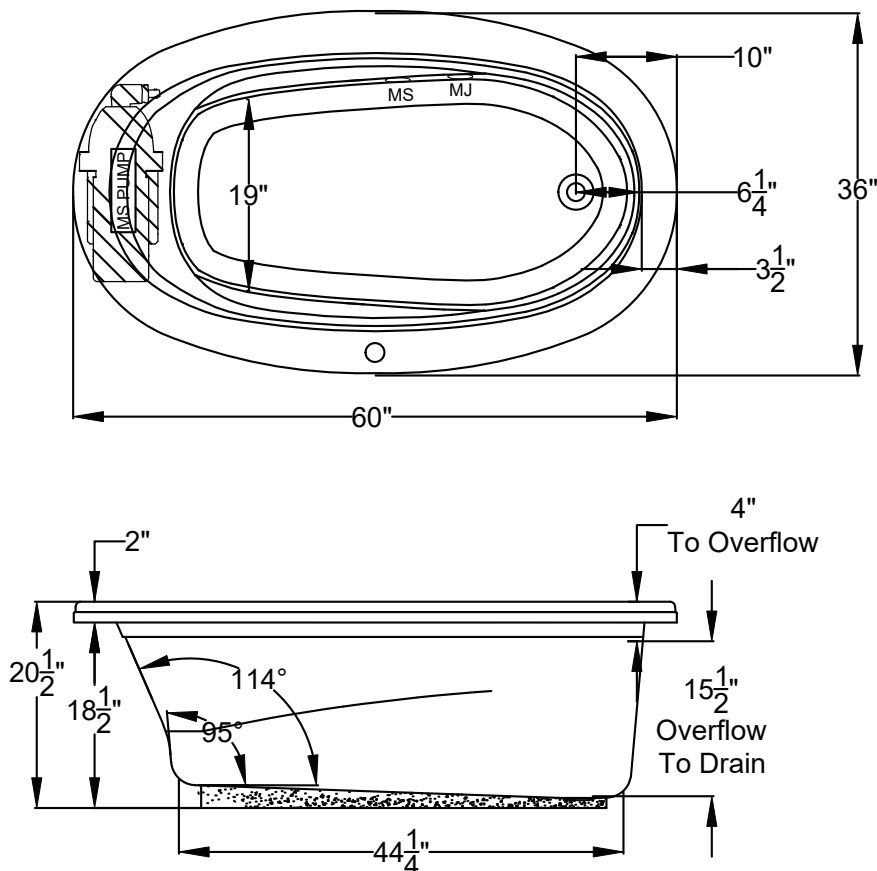

DROP-IN HOLE SIZE

Note: Equipment may extend beyond the outside perimeter of the bath.  
Consult factory for details.

Patents received or pending.

Note: Dimensional Tolerances:  $\pm 1/4$ "

**Drop-in Hole Size:** See Diagram  
**Operating Capacity:** 44 Gal.  
**Overflow Capacity:** 57 Gal.  
**Floor Loading / sq.ft.:** 57.2 lbs.  
**Carton Wt.:** 108 lbs.  
**Cube:** 31.3 ft.<sup>3</sup>

Air Switch Control

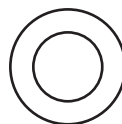

Includes a quiet, 120V MicroSilk<sup>®</sup> System, 1 MicroSilk<sup>®</sup> Delivery Port. Requires (1) 20A, 120v GFCI protected circuit.

**Construction:** Reinforced Acrylic shell mounted on Level Form<sup>™</sup> pre-leveled full support base.

We provide products listed with Intertek ETL SEMKO (Edison Testing Laboratories) U.S. and Canadian and with International Association of Plumbing and Mechanical Officials (IAPMO). Consult factory with your listing requirements.