

8328 MacArthur Dr. • North Little Rock, AR 72118
501.771.4477 • Fax: 501.771.2333
Customer Service: 800.255.5766
EMail: tech@jasonhydrotherapy.com
www.jasonhydrotherapy.com



Integrity® Collection Specifications

V4266

Whirlpool & Soaking

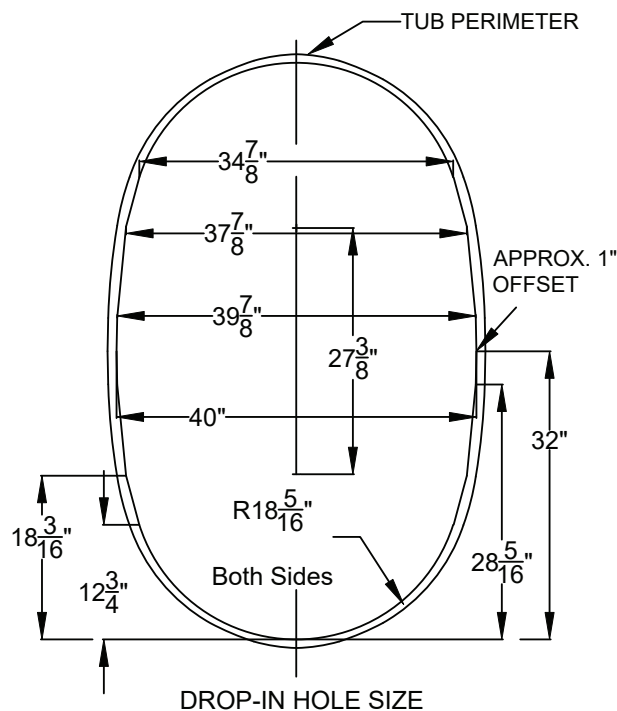
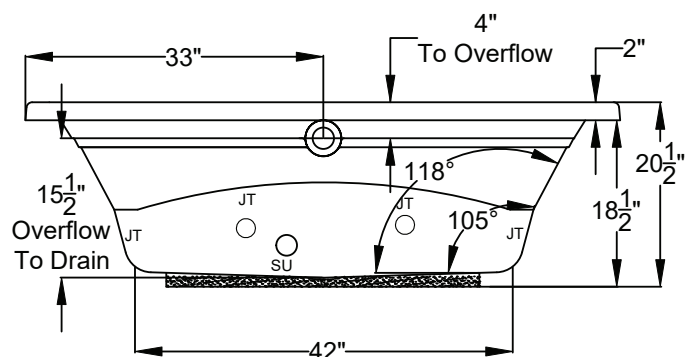
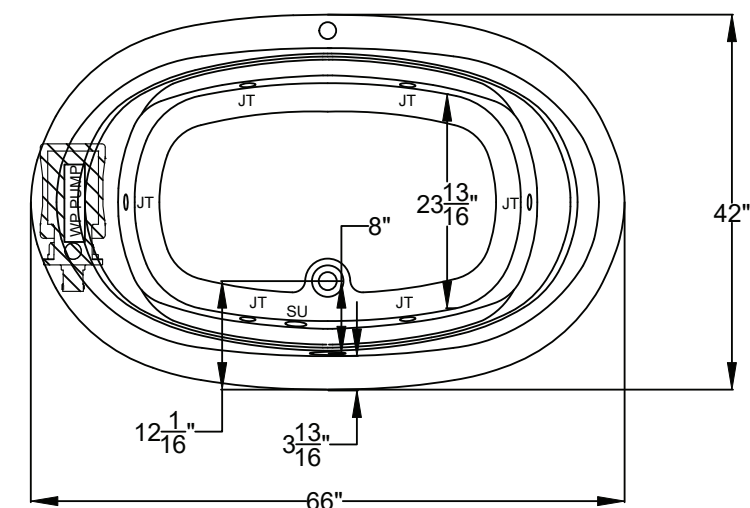

Patents received or pending.

Note: Dimensional Tolerances: $\pm 1/4"$

Drop-in Hole Size: See Diagram

Operating Capacity: 43 Gal.

Overflow Capacity: 70 Gal.

Floor Loading / sq.ft. (WP/Soaking): 43.9 / 41.4 lbs.

Carton Wt. (WP/Soaking): 106 / 72 lbs.

Cube: 39.7 ft.³

Air Switch Control

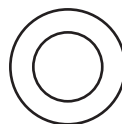

Includes a quiet, 120v, 1HP, 1-speed pump and an air switch on/off control. Requires (1) 20A, 120v GFCI protected circuit.

Construction: Reinforced Acrylic shell mounted on Level Form™ pre-leveled full support base.

We provide products listed with Intertek ETL SEMKO (Edison Testing Laboratories) U.S. and Canadian and with International Association of Plumbing and Mechanical Officials (IAPMO). Consult factory with your listing requirements.

Note: The blower extends approximately 1" past the end radius of the bath. This requires angling the bath into the drop-in hole.

© 2023 Jason® Hydrotherapy