

“TO BE REMOVED FOR USE BY THE OCCUPANT.”

Jason Hydrotherapy
8328 MacArthur Drive North
Little Rock, AR 72118
www.jasonhydrotherapy.com
MADE IN THE U.S.A.



JASON
HYDROTHERAPY

49-2034-003
Date 11/14

OWNER'S MANUAL

Metal Trim Kit

INSTALLATION INSTRUCTIONS

MOUNTING THE JF JET ESCUTCHEONS

1. Grip the Jet Escutcheon and pull outward to remove the escutcheon.
2. To replace with metal Jet Escutcheon, line up jet escutcheon with jet well fitting and press on until it snaps into place.

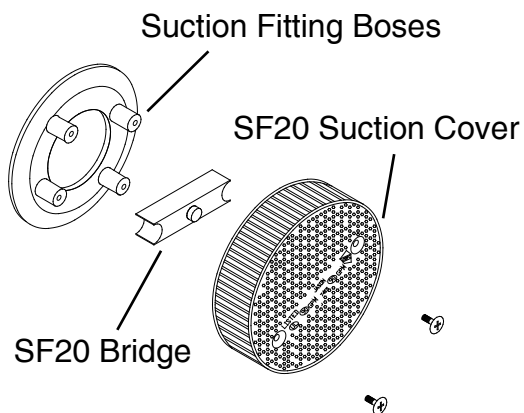
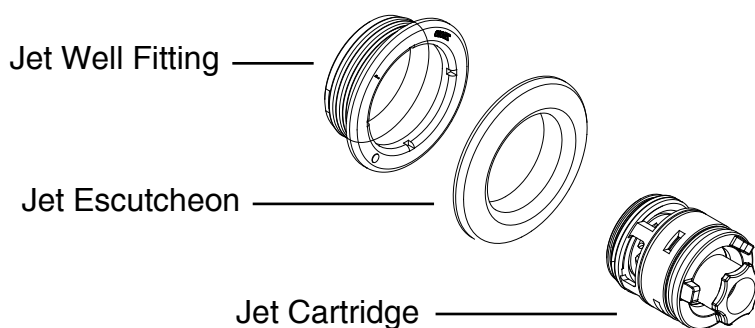

MOUNTING THE SF20 SUCTION COVER

1. Using a Phillips head screwdriver loosen the two screws which hold the Suction Cover in place and remove.
2. The SF20 Bridge, which is factory installed between any two boses on the suction fitting flange, must remain in place!
IMPORTANT! This is a safety device which must not be removed.
3. Place the metal plated SF20 Suction Cover over the suction cover flange and SF20 Bridge, aligning the outside ports on the cover in a horizontal orientation. Also make sure the holes on the front of the cover align with holes in the center of the boses.
4. Fasten the SF20 Cover with the Phillips screws provided.