

<div><div><div>S</div></div><div>SOAKING</div><div>Includes Level-Form™ Base</div></div> <div><div>\$3,305</div><div>(1185.00.00.CC)</div></div> <div><div>All hydrotherapy equipment is rated for 120V, 20A (US) Consult Spec Sheet on website for Boxed Weight & Cube. .CC = Color Code / See page 155 for color options.</div><div>Operating Cap: 56 U.S. Gal.</div></div>		STANDARD	PREMIER
		<div>Includes:</div> <div><div>• Linear Overflow Drain</div><div>• Touch Control Pad</div><div>• 20-minute timer</div></div>	<div>All Standard features plus:</div> <div><div>• Ozone</div><div>• Digital Control Pad</div><div>• LED Chromatherapy</div></div>
<div><div>W</div><div>WHIRLPOOL</div></div>	<div>Includes 6 adjustable jets with pump unit indicated.</div>	<div>\$6,445</div> <div>(1185.00.11.CC)</div>	<div>\$7,665</div> <div>with Whirlpool heater</div> <div>(1185.00.15.CC)</div>
<div><div>a</div><div>AIRMASSEUR®</div></div>	<div>Includes 40 strategically located air jets, 1hp blower w/ heater.</div>	<div>\$6,545</div> <div>(1185.00.21.CC)</div>	<div>\$7,765</div> <div>(1185.00.25.CC)</div>
<div><div>m</div><div>MICROSILK®</div></div>	<div>Includes 1 MicroSilk delivery port, MicroSilk unit.</div>	<div>\$6,305</div> <div>(1185.00.61.CC)</div>	<div>\$7,525</div> <div>(1185.00.65.CC)</div>
<div><div>aw</div><div>AIRMASSEUR® WHIRLPOOL</div></div>	<div>Includes 6 adjustable jets and 40 air jets; 1.5 hp pump; 1hp blower w/ heater. Combines all features provided with both <div>W</div> & <div>a</div> equipped Standard or Premier baths, respectively.</div>	<div>\$8,385</div> <div>(1185.00.31.CC)</div>	<div>\$9,605</div> <div>with Whirlpool heater</div> <div>(1185.00.35.CC)</div>
<div><div>mw</div><div>MICROSILK® WHIRLPOOL</div></div>	<div>Includes 6 adjustable jets and 1 MicroSilk delivery port; MicroSilk unit; 1.5 hp pump. Combines all features provided with both <div>W</div> & <div>m</div> equipped Standard or Premier baths, respectively.</div>	<div>\$9,440</div> <div>(1185.00.71.CC)</div>	<div>\$10,660</div> <div>with Whirlpool heater</div> <div>(1185.00.75.CC)</div>
<div><div>ma</div><div>MICROSILK® AIRMASSEUR®</div></div>	<div>Includes 1 MicroSilk delivery port, 40 strategically located air jets; MicroSilk unit; 1hp blower w/ heater. Combines all features provided with both <div>a</div> & <div>m</div> equipped Standard or Premier baths, respectively.</div>	<div>\$9,545</div> <div>(1185.00.81.CC)</div>	<div>\$10,765</div> <div>(1185.00.85.CC)</div>

Control pad can be mounted on opposing side of vessel by request.

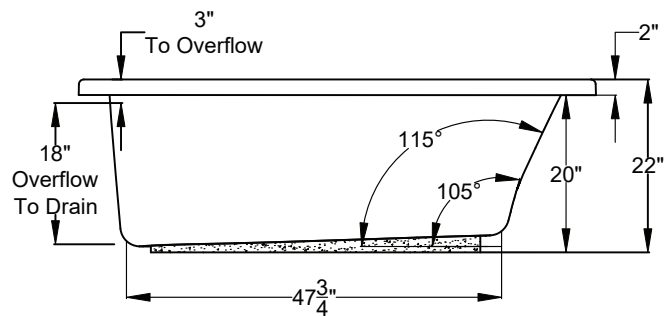
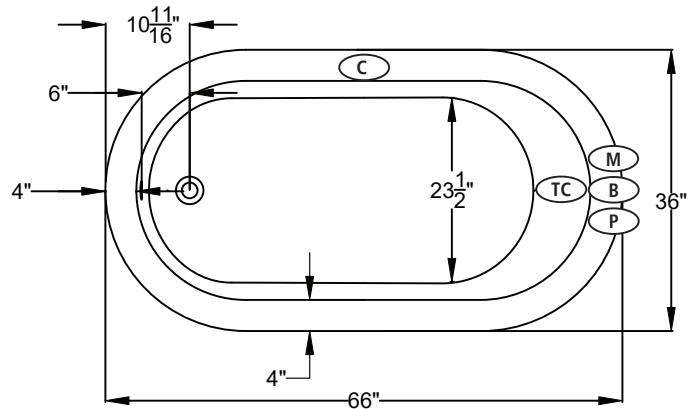

NOTE: **(mw)** MicroSilk[®] equipment may extend beyond the perimeter of the bath. Consult factory for details.

Bath Options

For handle information, see page 127.
For details & additional options, see page 128-130.

GH400 HANDLE - Factory installed. Accepts 2 handles. Price is per handle. If ordering 1 handle, indicate handle installation.		8709-04-0CC	\$315
JETTED NECK PILLOW - Page 128 (W) (mw)		8707-50-0CC	\$1,145
BACKSTACK™ JETS - Page 128 (W) (mw)		8707-30-001	\$930
BLUETOOTH SOUND IMMERSION SYSTEM - Page 128		8724-01-000	\$835
WATER LEVEL SENSOR - Page 128		8724-02-000	\$1,030
THERMO COMFORT - Page 129 (S) (W) (m) (mw)		8706-04-XXX	\$840
MICROSILK SHOWER WAND - Page 129	Polished Chrome	8705-55-091	\$505
	Optional Finishes	MLD-XX	ADD \$120
LINEAR OVERFLOW DRAIN KITS - For finish options, see Page 129.		MLD-PC	Included
		MLD-XX	ADD \$120

- (C)** Control Location
- (M)** MicroSilk[®] Unit Location
- (P)** Whirlpool Pump Location
- (B)** Blower Location
- (TC)** Thermo Comfort Heating Pad Location

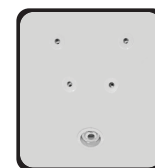

1 set of
Back-Stack™ jets
on **(W)** **(mw)**
(Optional)