

UNDERMOUNTABLE: No

FAUCETRY DECK: No

TEXTURED FLOOR: No

(S)

**SOAKING**

Includes Level-Form™ Base

**\$5,350**  
(2202.08.00.CC)

All hydrotherapy equipment is rated for 120V, 20A (US)  
Consult Spec Sheet on website for Boxed Weight & Cube.  
.CC = Color Code / See page 155 for color options.

Operating Cap: 42 U.S. Gal.

**STANDARD**

Includes:

- 120V Systems
- Touch Control Pad
- 20-minute timer

**PREMIER**

All Standard features plus:

- Ozone
- Digital Control Pad
- LED Chromatherapy

(a)

**AIRMASSEUR<sup>®</sup>**

Includes 44 strategically located air jets, 1hp blower w/ heater.

**\$8,590**  
(2202.08.21.CC)

**\$9,810**  
(2202.08.25.CC)

(m)

**MICROSILK<sup>®</sup>**

Includes 1 MicroSilk delivery port, MicroSilk unit.

**\$9,050**  
(2202.08.61.CC)

**\$10,270**  
(2202.08.65.CC)



\*Shown with optional  
Pedestal Skirt Ring Base.

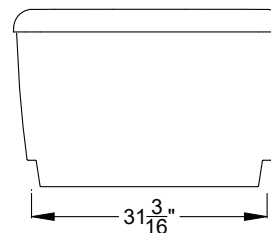
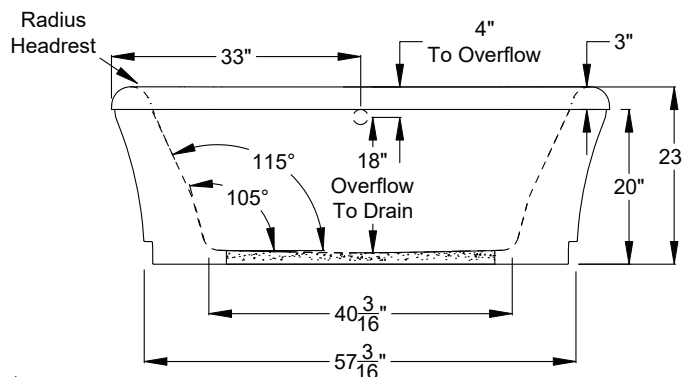
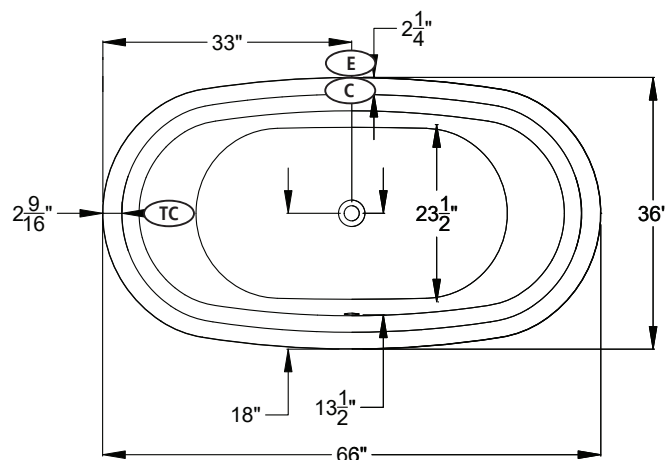

(C)

Control Location

(E)

Equipment Cabinet

(TC)

Thermo Comfort Heating Pad Location



The Acrylic Equipment Cabinet is required on MicroSilk<sup>®</sup> baths and is available as an option on Airmasseur<sup>®</sup> baths.

## Bath Options

For handle information, see page 127.

For details & additional options, see page 128-130.

<b>GH20 HANDLE</b> - Factory installed. Accepts 1 handle across from overflow.	8709-24-0CC	\$240
<b>ACRYLIC EQUIPMENT CABINET</b> - Page 129 (a)	8701-10-0CC	\$1,025
<b>PEDESTAL SKIRT RING BASE</b>	32-5500-001	\$980
<b>BLUETOOTH SOUND IMMERSION SYSTEM</b> - Page 128	8724-01-000	\$835
<b>WATER LEVEL SENSOR</b> - Page 128	8724-02-000	\$1,030
<b>THERMO COMFORT</b> - Page 129 (S) (a) (m)	8706-04-XXX	\$840
<b>MICROSILK SHOWER WAND</b> - Page 129	Polished Chrome 8705-55-091	\$505
<b>DESIGNER OVERFLOW DRAIN KITS</b> - For finish options, see Page 129.	Polished Chrome DDK-PC	\$160
	Optional Finishes DDK-XX	\$275