

UNDERMOUNTABLE: No

FAUCETRY DECK: Yes

TEXTURED FLOOR: No

(S)

SOAKING

Includes Level-Form™ Base

\$6,100
(2206.09.00.CC)

All hydrotherapy equipment is rated for 120V, 20A (US)
Consult Spec Sheet on website for Boxed Weight & Cube.
.CC = Color Code / See page 155 for color options.

Operating Cap: 41 U.S. Gal.

STANDARD

Includes:

- 120V Systems
- Touch Control Pad
- 20-minute timer

PREMIER

All Standard features plus:

- Ozone
- Digital Control Pad
- LED Chromatherapy

(a)
AIRMASSEUR[®]

Includes 35 strategically located air jets, 1hp blower w/ heater.

\$9,340
(2206.09.21.CC)

\$10,560
(2206.09.25.CC)

(m)
MICROSILK[®]

Includes 1 MicroSilk delivery port, MicroSilk unit.

\$9,800
(2206.09.61.CC)

\$11,020
(2206.09.65.CC)

(ma)
**MICROSILK[®]
AIRMASSEUR[®]**

Includes 1 MicroSilk delivery port, 35 strategically located air jets; MicroSilk unit; 1hp blower w/ heater.
Combines all features provided with both (a) & (m) equipped Standard or Premier baths, respectively.

\$13,040
(2206.09.81.CC)

\$14,260
(2206.09.85.CC)

Designer
FREESTANDING

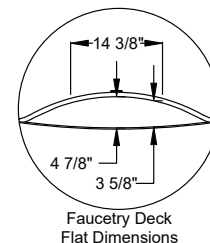
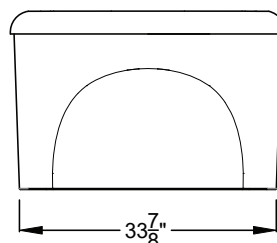
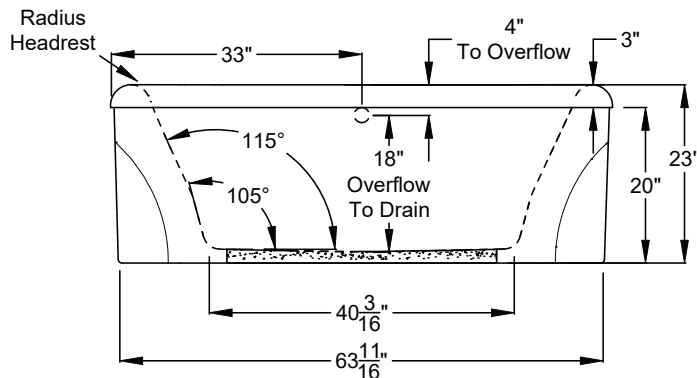
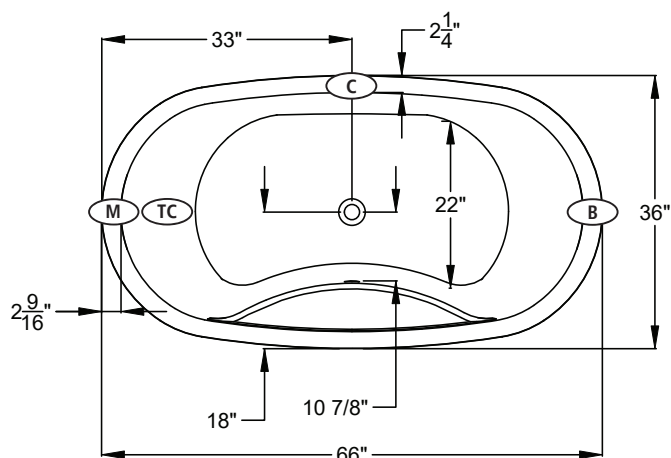

(C) Control Location

(B) Blower Location

(M) MicroSilk[®] Unit Location

(TC) Thermo Comfort Heating Pad Location

Bath Options

For handle information, see page 127.

For details & additional options, see page 128-130.

GH20 HANDLE - Factory installed. Accepts 1 handle across from overflow.	8709-24-0CC	\$240
INTEGRATED ACCESS PANELS (Both Ends)		Included
BLUETOOTH SOUND IMMERSION SYSTEM - Page 128	8724-01-000	\$835
WATER LEVEL SENSOR - Page 128	8724-02-000	\$1,030
THERMO COMFORT - Page 129 (S) (a) (m) (ma)	8706-04-XXX	\$840
MICROSILK SHOWER WAND - Page 129	Polished Chrome 8705-55-091	\$505
DESIGNER OVERFLOW DRAIN KITS - For finish options, see Page 129.	Polished Chrome DDK-PC	\$160
	Optional Finishes DDK-XX	\$275