

UNDERMOUNTABLE: Yes

FAUCETRY DECK: No

TEXTURED FLOOR: Yes

<div> <div><b>(S)</b></div> <div><b>SOAKING</b></div> <div>Includes Level-Form™ Base</div> </div> <div> <div><b>\$3,475</b></div> <div><b>(2145.00.00.CC)</b></div> </div> <div> <div>All hydrotherapy equipment is rated for 120V, 20A (US) Consult Spec Sheet on website for Boxed Weight &amp; Cube. .CC = Color Code / See page 155 for color options.</div> <div>Operating Cap: 54 U.S. Gal.</div> </div>		STANDARD	PREMIER
<div><b>(W)</b></div> <div><b>WHIRLPOOL</b></div> <div>Includes 6 adjustable jets with pump unit indicated.</div>		<div><b>\$6,615</b></div> <div><b>(2145.00.11.CC)</b></div>	<div><b>\$7,835</b></div> <div>with Whirlpool heater</div> <div><b>(2145.00.15.CC)</b></div>
<div><b>(a)</b></div> <div><b>AIRMASSEUR<sup>®</sup></b></div> <div>Includes 56 strategically located air jets, 1hp blower w/ heater.</div>		<div><b>\$6,715</b></div> <div><b>(2145.00.21.CC)</b></div>	<div><b>\$7,935</b></div> <div><b>(2145.00.25.CC)</b></div>
<div><b>(m)</b></div> <div><b>MICROSILK<sup>®</sup></b></div> <div>Includes 1 MicroSilk delivery port, MicroSilk unit.</div>		<div><b>\$6,475</b></div> <div><b>(2145.00.61.CC)</b></div>	<div><b>\$7,695</b></div> <div><b>(2145.00.65.CC)</b></div>
<div><b>(aw)</b></div> <div><b>AIRMASSEUR<sup>®</sup> WHIRLPOOL</b></div> <div>Includes 6 adjustable jets and 56 air jets; 1.5 hp pump; 1hp blower w/ heater. Combines all features provided with both <b>(W)</b> &amp; <b>(a)</b> equipped Standard or Premier baths, respectively.</div>		<div><b>\$8,555</b></div> <div><b>(2145.00.31.CC)</b></div>	<div><b>\$9,775</b></div> <div>with Whirlpool heater</div> <div><b>(2145.00.35.CC)</b></div>
<div><b>(mw)</b></div> <div><b>MICROSILK<sup>®</sup> WHIRLPOOL</b></div> <div>Includes 6 adjustable jets and 1 MicroSilk delivery port; MicroSilk unit; 1.5 hp pump. Combines all features provided with both <b>(W)</b> &amp; <b>(m)</b> equipped Standard or Premier baths, respectively.</div>		<div><b>\$9,610</b></div> <div><b>(2145.00.71.CC)</b></div>	<div><b>\$10,830</b></div> <div>with Whirlpool heater</div> <div><b>(2145.00.75.CC)</b></div>
<div><b>(ma)</b></div> <div><b>MICROSILK<sup>®</sup> AIRMASSEUR<sup>®</sup></b></div> <div>Includes 1 MicroSilk delivery port, 56 strategically located air jets; MicroSilk unit; 1hp blower w/ heater. Combines all features provided with both <b>(a)</b> &amp; <b>(m)</b> equipped Standard or Premier baths, respectively.</div>		<div><b>\$9,715</b></div> <div><b>(2145.00.81.CC)</b></div>	<div><b>\$10,935</b></div> <div><b>(2145.00.85.CC)</b></div>

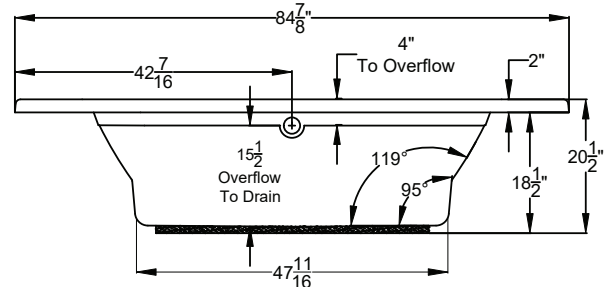
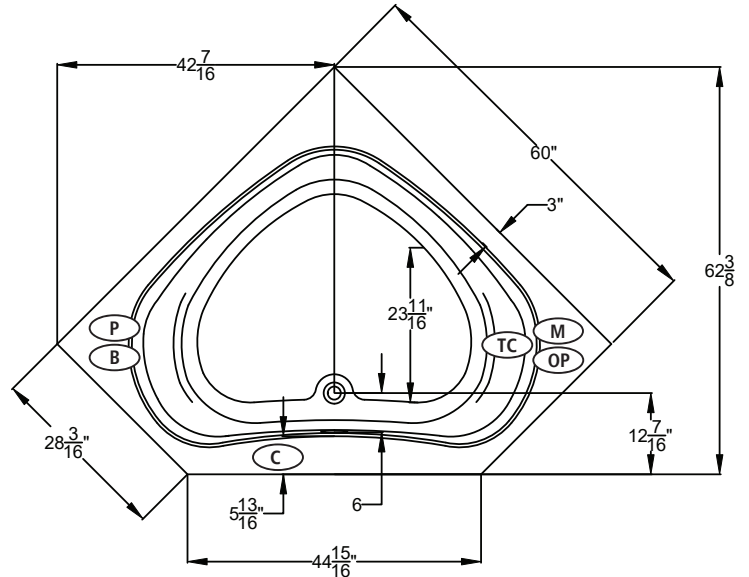

### Bath Options

For handle information, see page 127.  
For details & additional options, see page 128-130.

<b>GH20 HANDLE</b> - Factory installed. Accepts 2 handles. Price is per handle. If ordering 1 handle, indicate handle installation.		8709-24-0CC	\$240
<b>JETTED NECK PILLOW</b> - Page 128 <b>(W)</b> <b>(aw)</b> <b>(mw)</b>		8707-50-0CC	\$1,145
<b>BACKSTACK™ JETS</b> - Page 128 <b>(W)</b> <b>(mw)</b>		8707-30-001	\$930
<b>BLUETOOTH SOUND IMMERSION SYSTEM</b> - Page 128		8724-01-000	\$835
<b>WATER LEVEL SENSOR</b> - Page 128		8724-02-000	\$1,030
<b>THERMO COMFORT</b> - Page 129		8706-04-XXX	\$840
<b>MICROSILK SHOWER WAND</b> - Page 129	Polished Chrome	8705-55-091	\$505
	Optional Finishes	DDK-XX	\$275
<b>DESIGNER OVERFLOW DRAIN KITS</b> - For finish options, see Page 129.		DDK-PC	\$160
<b>TILE FLANGE KIT</b> - Page 129		8707-11-001	\$190

**(P)** Whirlpool Pump Location

**(M)** MicroSilk<sup>®</sup> Unit Location

**(C)** Control Location

**(B)** Blower Location

**(TC)** Thermo Comfort Heating Pad Location

**(OP)** Optional pump location available on **(W)** only. Please designate pump location.

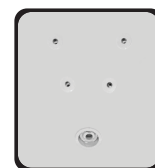

1 set of  
Back-Stack™ jets  
on **(W)** **(mw)**  
(Optional)