

<div> <div>(S)</div> <div><b>SOAKING</b></div> <div>Includes Level-Form™ Base</div> </div> <div> <div><b>\$3,295</b></div> <div>(2155.00.00.CC)</div> </div> <div> <div>All hydrotherapy equipment is rated for 120V, 20A (US) Consult Spec Sheet on website for Boxed Weight &amp; Cube. .CC = Color Code / See page 155 for color options.</div> <div>Operating Cap: 49 U.S. Gal.</div> </div>		STANDARD	PREMIER
<div>(W)</div> <div><b>WHIRLPOOL</b></div> <div>Includes 5 adjustable jets and 2 foot jets with pump unit indicated.</div>		<div><b>\$6,435</b></div> <div>(2155.00.11.CC)</div>	<div><b>\$7,655</b></div> <div>with Whirlpool heater</div> <div>(2155.00.15.CC)</div>
<div>(a)</div> <div><b>AIRMASSEUR<sup>®</sup></b></div> <div>Includes 44 strategically located air jets, 1hp blower w/ heater.</div>		<div><b>\$6,535</b></div> <div>(2155.00.21.CC)</div>	<div><b>\$7,755</b></div> <div>(2155.00.25.CC)</div>
<div>(m)</div> <div><b>MICROSILK<sup>®</sup></b></div> <div>Includes 1 MicroSilk delivery port, MicroSilk unit.</div>		<div><b>\$6,295</b></div> <div>(2155.00.61.CC)</div>	<div><b>\$7,515</b></div> <div>(2155.00.65.CC)</div>
<div>(aw)</div> <div><b>AIRMASSEUR<sup>®</sup> WHIRLPOOL</b></div> <div>Includes 5 adjustable jets, 2 foot jets and 44 air jets; 1.5 hp pump; 1hp blower w/ heater. Combines all features provided with both (W) &amp; (a) equipped Standard or Premier baths, respectively.</div>		<div><b>\$8,375</b></div> <div>(2155.00.31.CC)</div>	<div><b>\$9,595</b></div> <div>with Whirlpool heater</div> <div>(2155.00.35.CC)</div>
<div>(mw)</div> <div><b>MICROSILK<sup>®</sup> WHIRLPOOL</b></div> <div>Includes 5 adjustable jets, 2 foot jets and 1 MicroSilk delivery port; MicroSilk unit; 1.5 hp pump. Combines all features provided with both (W) &amp; (m) equipped Standard or Premier baths, respectively.</div>		<div><b>\$9,430</b></div> <div>(2155.00.71.CC)</div>	<div><b>\$10,650</b></div> <div>with Whirlpool heater</div> <div>(2155.00.75.CC)</div>
<div>(ma)</div> <div><b>MICROSILK<sup>®</sup> AIRMASSEUR<sup>®</sup></b></div> <div>Includes 1 MicroSilk delivery port, 44 strategically located air jets; MicroSilk unit; 1hp blower w/ heater. Combines all features provided with both (a) &amp; (m) equipped Standard or Premier baths, respectively.</div>		<div><b>\$9,535</b></div> <div>(2155.00.81.CC)</div>	<div><b>\$10,755</b></div> <div>(2155.00.85.CC)</div>

Control pad can be mounted on opposing side of vessel by request.

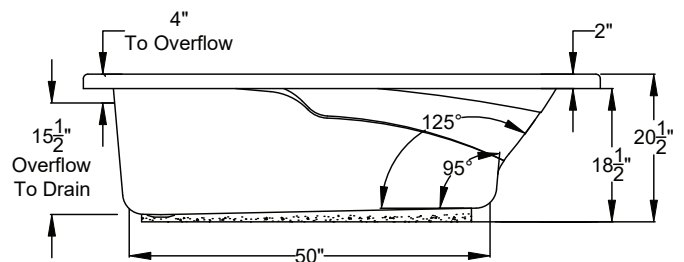
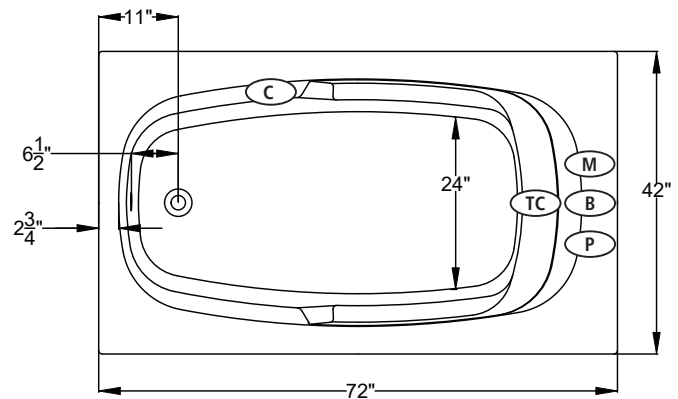

### Bath Options

For handle information, see page 127.  
For details & additional options, see page 128-130.

<b>GH400 HANDLE</b> - Factory installed. Accepts 2 handles. Price is per handle. If ordering 1 handle, indicate handle installation.		8709-04-0CC	\$315
<b>JETTED NECK PILLOW</b> - Page 128 (W) (aw) (mw)		8707-50-0CC	\$1,145
<b>BACKSTACK™ JETS</b>			N/A
<b>BLUETOOTH SOUND IMMERSION SYSTEM</b> - Page 128		8724-01-000	\$835
<b>WATER LEVEL SENSOR</b> - Page 128		8724-02-000	\$1,030
<b>THERMO COMFORT</b> - Page 129 (S) (W) (m) (mw)		8706-04-XXX	\$840
<b>MICROSILK SHOWER WAND</b> - Page 129		Polished Chrome 8705-55-091	\$505
<b>DESIGNER OVERFLOW DRAIN KITS</b> - For finish options, see Page 129.		Polished Chrome DDK-PC	\$160
		Optional Finishes DDK-XX	\$275
<b>TILE FLANGE KIT</b> - Page 129		8707-11-001	\$190
<b>LATERAL SKIRT</b> - Page 131		8700-03-0CC	\$1,165

(C) Control Location

(B) Blower Location

(M) MicroSilk<sup>®</sup> Unit Location

(TC) Thermo Comfort Heating Pad Location

(P) Whirlpool Pump Location