

<div><div><div>S</div></div><div>SOAKING</div></div> <div>Includes Level-Form™ Base</div>		All hydrotherapy equipment is rated for 120V, 20A (US) Consult Spec Sheet on website for Boxed Weight & Cube. .CC = Color Code / See page 155 for color options.	STANDARD	PREMIER
Operating Cap: 32 U.S. Gal.			Includes: <ul style="list-style-type: none"><li>• 120V Systems</li><li>• Touch Control Pad</li><li>• 20-minute timer</li></ul>	All Standard features plus: <ul style="list-style-type: none"><li>• Ozone</li><li>• Digital Control Pad</li><li>• LED Chromatherapy</li></ul>
<div><div><div>W</div></div><div>WHIRLPOOL</div></div>	Includes 5 adjustable jets, 2 foot jets, and 4 BackStack™ jets with pump unit indicated.	<div>\$7,330</div> <div>(2189.00.11.CC)</div>	<div>\$8,550</div> <div>with Whirlpool heater</div> <div>(2189.00.15.CC)</div>	
<div><div><div>a</div></div><div>AIRMASSEUR®</div></div>	Includes 40 strategically located air jets, 1hp blower w/ heater.	<div>\$6,630</div> <div>(2189.00.21.CC)</div>	<div>\$7,850</div> <div>(2189.00.25.CC)</div>	
<div><div><div>m</div></div><div>MICROSILK®</div></div>	Includes 1 MicroSilk delivery port, MicroSilk unit.	<div>\$6,390</div> <div>(2189.00.61.CC)</div>	<div>\$7,610</div> <div>(2189.00.65.CC)</div>	
<div><div><div>aw</div></div><div>AIRMASSEUR® WHIRLPOOL</div></div>	Includes 5 adjustable jets, 2 foot jets, 4 BackStack™ jets and 40 air jets; 1.5 hp pump; 1hp blower w/ heater. Combines all features provided with both <div><div>W</div></div> & <div><div>a</div></div> equipped Standard or Premier baths, respectively.	<div>\$9,270</div> <div>(2189.00.31.CC)</div>	<div>\$10,490</div> <div>with Whirlpool heater</div> <div>(2189.00.35.CC)</div>	
<div><div><div>mw</div></div><div>MICROSILK® WHIRLPOOL</div></div>		N/A	N/A	
<div><div><div>ma</div></div><div>MICROSILK® AIRMASSEUR®</div></div>	Includes 1 MicroSilk delivery port, 40 strategically located air jets; MicroSilk unit; 1hp blower w/ heater. Combines all features provided with both <div><div>a</div></div> & <div><div>m</div></div> equipped Standard or Premier baths, respectively.	<div>\$9,630</div> <div>(2189.00.81.CC)</div>	<div>\$10,850</div> <div>(2189.00.85.CC)</div>	

Control pad can be mounted on opposing side of vessel by request.

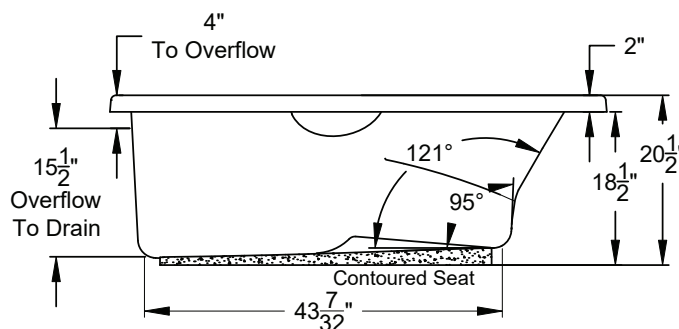
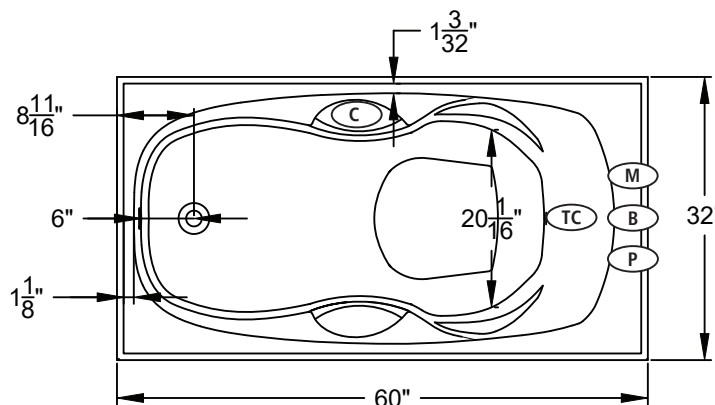
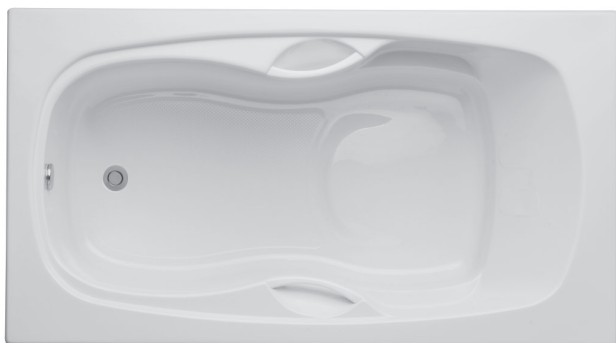

\*Blower must be remote mounted on MicroSilk®-AirMasseur® and Air-Whirlpool baths. See page 130 for remote blower mounting.

Bath Options		For handle information, see page 127.
For details & additional options, see page 128-130.		
ACRYLIC HANDLES - Factory installed.		Included
JETTED NECK PILLOW - Page 128 (W)	8707-50-0CC	\$1,145
BACKSTACK™ JETS - Page 128 (W) (aw)		Included
BLUETOOTH SOUND IMMERSION SYSTEM - Page 128	8724-01-000	\$835
WATER LEVEL SENSOR - Page 128	8724-02-000	\$1,030
THERMO COMFORT - Page 129 (S) (W) (m)	8706-04-XXX	\$840
MICROSILK SHOWER WAND - Page 129	Polished Chrome 8705-55-091	\$505
DESIGNER OVERFLOW DRAIN KITS - For finish options, see Page 129.	Polished Chrome DDK-PC	\$160
	Optional Finishes DDK-XX	\$275
TILE FLANGE KIT - Page 129	8707-11-001	\$190
LATERAL SKIRT - Page 131	8700-01-0CC	\$1,165

- C** Control Location
- M** MicroSilk® Unit Location
- P** Whirlpool Pump Location
- B** Blower Location
- TC** Thermo Comfort Heating Pad Location

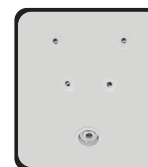

1 set of  
Back-Stack™ jets  
on **(w)** **(aw)**  
(Included)