

<div> <div>(S)</div> SOAKING Includes Level-Form[™] Base </div> <div> \$3,475 (2106.00.00.CC) </div> <div> <small>All hydrotherapy equipment is rated for 120V, 20A (US) Consult Spec Sheet on website for Boxed Weight & Cube. .CC = Color Code / See page 155 for color options.</small> Operating Cap: 58 U.S. Gal. </div>		STANDARD	PREMIER
<div>(W)</div> WHIRLPOOL Includes 6 adjustable jets with pump unit indicated.		\$6,615 (2106.00.11.CC)	\$7,835 with Whirlpool heater (2106.00.15.CC)
<div>(a)</div> AIRMASSEUR[®] Includes 48 strategically located air jets, 1hp blower w/ heater.		\$6,715 (2106.00.21.CC)	\$7,935 (2106.00.25.CC)
<div>(m)</div> MICROSILK[®] Includes 1 MicroSilk delivery port, MicroSilk unit.		\$6,475 (2106.00.61.CC)	\$7,695 (2106.00.65.CC)
<div>(aw)</div> AIRMASSEUR[®] WHIRLPOOL Includes 6 adjustable jets and 48 air jets; 1.5 hp pump; 1hp blower w/ heater. Combines all features provided with both (W) & (a) equipped Standard or Premier baths, respectively.		\$8,555 (2106.00.31.CC)	\$9,775 with Whirlpool heater (2106.00.35.CC)
<div>(mw)</div> MICROSILK[®] WHIRLPOOL Includes 6 adjustable jets and 1 MicroSilk delivery port; MicroSilk unit; 1.5 hp pump. Combines all features provided with both (W) & (m) equipped Standard or Premier baths, respectively.		\$9,610 (2106.00.71.CC)	\$10,830 with Whirlpool heater (2106.00.75.CC)
<div>(ma)</div> MICROSILK[®] AIRMASSEUR[®] Includes 1 MicroSilk delivery port, 48 strategically located air jets; MicroSilk unit; 1hp blower w/ heater. Combines all features provided with both (a) & (m) equipped Standard or Premier baths, respectively.		\$9,715 (2106.00.81.CC)	\$10,935 (2106.00.85.CC)

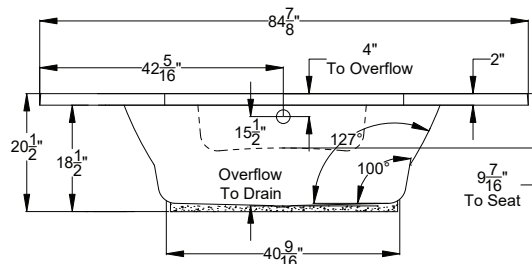
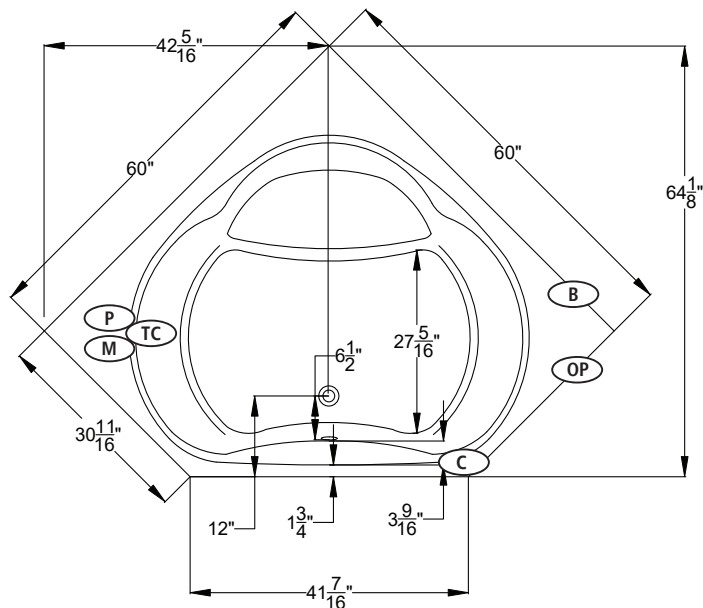

(P) Whirlpool Pump Location

(M) MicroSilk[®] Unit Location

(C) Control Location

(B) Blower Location

(TC) Thermo Comfort Heating Pad Location

(OP) Optional pump location available on (W) only. Please designate pump location.

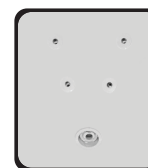

1 set of
Back-Stack[™] jets
on (W) (MW)
(Optional)

Bath Options

For handle information, see page 127.
For details & additional options, see page 128-130.

ACRYLIC HANDLE		N/A
JETTED NECK PILLOW - Page 128 (W) (aw) (mw)	8707-50-0CC	\$1,145
BACKSTACK [™] JETS - Page 128 (W) (mw)	8707-30-001	\$930
BLUETOOTH SOUND IMMERSION SYSTEM - Page 128	8724-01-000	\$835
WATER LEVEL SENSOR - Page 128	8724-02-000	\$1,030
THERMO COMFORT - Page 129	8706-04-XXX	\$840
MICROSILK SHOWER WAND - Page 129	Polished Chrome 8705-55-091	\$505
DESIGNER OVERFLOW DRAIN KITS - For finish options, see Page 129.	Polished Chrome DDK-PC	\$160
	Optional Finishes DDK-XX	\$275
TILE FLANGE KIT - Page 129	8707-11-001	\$190