

UNDERMOUNTABLE: No

FAUCETRY DECK: No

TEXTURED FLOOR: No

<div><div><div>(S)</div></div><div>SOAKING</div><div>Includes Level-Form™ Base</div></div> <div><div>\$2,835</div><div>(SL) = (3190.40.00.CC)</div><div>(SR) = (3190.50.00.CC)</div></div> <div><div>All hydrotherapy equipment is rated for 120V, 20A (US) Consult Spec Sheet on website for Boxed Weight & Cube. .CC = Color Code / See page 155 for color options.</div><div>Operating Cap: 39 U.S. Gal.</div></div> <div><div>End-Access Required.</div><div>Order Removable Access Panel for Front Access.</div></div>		SKIRT LEFT	SKIRT RIGHT
		<div><div>(W)</div><div>WHIRLPOOL</div></div> <div><div><div>• 1 hp, 120V pump - Air on/off control</div><div>• Includes 5 adjustable jets</div></div></div> <div><div>\$4,130</div><div>(3190.40.17.CC)</div></div> <div>(3190.50.17.CC)</div>	<div><div>(a)</div><div>AIRMASSEUR®</div></div> <div><div><div>• ¾ hp, 120V blower - Air on/off control with 20-minute timer & purge</div><div>• 38 strategically located air jets</div><div>• 20-minute timer with purge cycle</div></div></div> <div><div>\$4,660</div><div>(3190.40.27.CC)</div></div> <div>(3190.50.27.CC)</div>
<div><div>(m)</div><div>MICROSILK®</div></div> <div><div><div>• 120V MicroSilk® System - Air on/off control with a 20-minute timer</div><div>• Includes 1 MicroSilk® delivery port</div></div></div> <div><div>\$4,735</div><div>(3190.40.67.CC)</div></div> <div>(3190.50.67.CC)</div>			

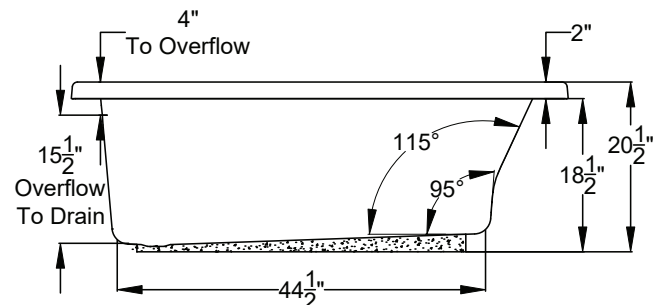
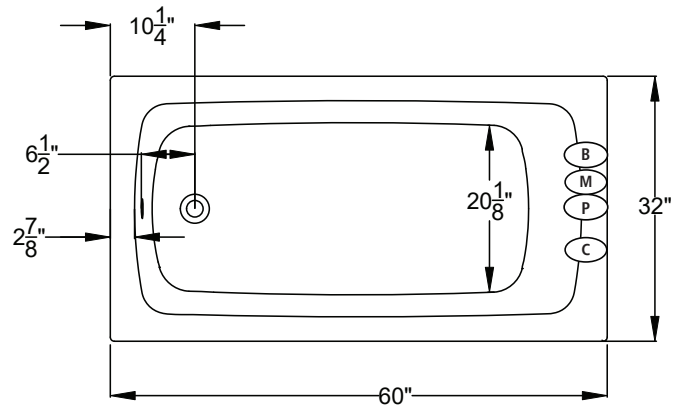
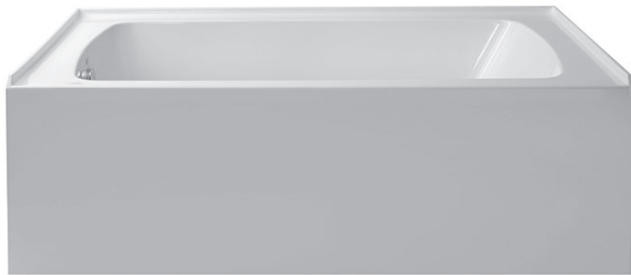

Bath Options

For handle information, see page 127.
For additional options and details, see page 128-130.

REMOVABLE FRONT ACCESS PANEL - Page 131 Factory Installed		8700-07-0CC	\$650
GH400 GRIP HANDLES Factory Installed. Accepts 2 handles. Price is per handle. If 1 handle is desired, indicate installation location.			\$240
AUTOMATIC OZONE SYSTEM - Page 128	(W) (M)	OZONE-100	\$700
	(a)	OZONE-200	\$700
STAINLESS STEEL HEATER - Page 128	(W)	8706-11-106	\$455
OVERFLOW DRAIN ASSEMBLY - Page 129 (Group BE)	WT	8705-15-001	\$275
	BQ	8705-15-040	\$275
	Polished Chrome	8705-15-091	\$160
	Polished Nickel	8705-15-092	\$275
	Brushed Nickel	8705-15-095	\$275
	Oil Rubbed Bronze	8705-15-098	\$275
MICROSILK SHOWER WAND - Page 129	Polished Chrome	8705-55-091	\$505
TILE FLANGE KIT - Page 129			N/A

(M) MicroSilk® Unit Location
(B) Blower Location

(P) Pump Location
(C) Control Location