

UNDERMOUNTABLE: Yes

FAUCETRY DECK: No

TEXTURED FLOOR: No

(S)

SOAKING

Includes Level-Form™ Base

\$2,410
(3190.00.00.CC)

All hydrotherapy equipment is rated for 120V, 20A (US)
Consult Spec Sheet on website for Boxed Weight & Cube.
.CC = Color Code / See page 155 for color options.

Operating Cap: 39 U.S. Gal.

(W)

WHIRLPOOL

- 1 hp, 120V pump - Air on/off control
- Includes 5 adjustable jets

\$3,705

(3190.00.17.CC)

(a)

AIRMASSEUR[®]

- ¾ hp, 120V blower - Air on/off control with 20-minute timer & purge
- 38 strategically located air jets
- 20-minute timer with purge cycle

\$4,235

(3190.00.27.CC)

(m)

MICROSILK[®]

- 120V MicroSilk[®] System - Air on/off control with a 20-minute timer
- Includes 1 MicroSilk[®] delivery port

\$4,310

(3190.00.67.CC)

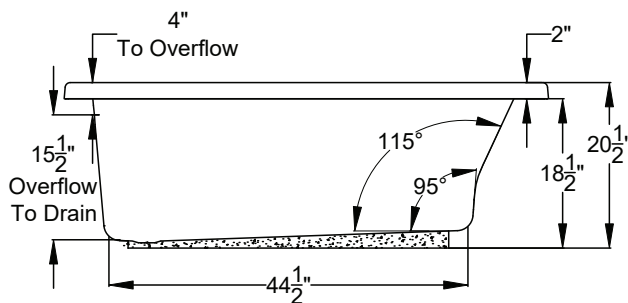
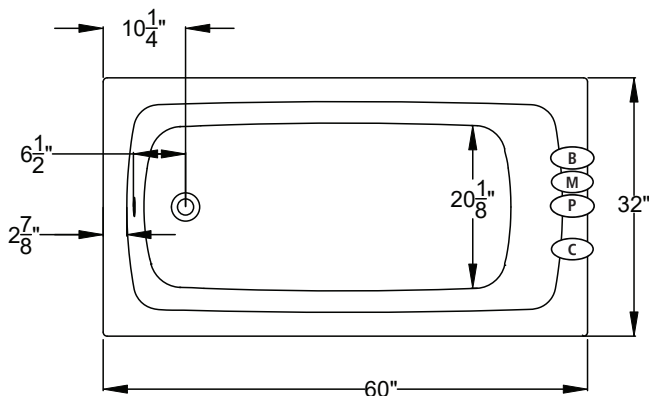

Bath Options

For handle information, see page 127.
For additional options and details, see page 128-130.

LATERAL SKIRT - Page 131 Field Installed	WT	8700-01-001	\$1,165
	BQ	8700-01-040	\$1,165
GH20 GRIP HANDLES	Factory Installed. Accepts 2 handles. Price is per handle. If 1 handle is desired, indicate installation location.		\$240
AUTOMATIC OZONE SYSTEM - Page 128	(W) (m)	OZONE-100	\$700
	(a)	OZONE-200	\$700
STAINLESS STEEL HEATER - Page 128	(W)	8706-11-106	\$455
OVERFLOW DRAIN ASSEMBLY - Page 129 (Group BE)	WT	8705-15-001	\$275
	BQ	8705-15-040	\$275
	Polished Chrome	8705-15-091	\$160
	Polished Nickel	8705-15-092	\$275
	Brushed Nickel	8705-15-095	\$275
	Oil Rubbed Bronze	8705-15-098	\$275
MICROSILK SHOWER WAND - Page 129	Polished Chrome	8705-55-091	\$505
TILE FLANGE KIT - Page 129		8707-11-001	\$190

(M) MicroSilk[®] Unit Location
(B) Blower Location

(P) Pump Location
(C) Control Location