

<div><div><div><div><div><div></div><div>S</div></div></div><div><div></div><div>SOAKING</div></div></div></div><div>Includes Level-Form™ Base</div></div> <div><div><div>\$3,300</div><div>SL = (2188.40.00.CC)</div><div>SR = (2188.50.00.CC)</div></div></div> <div><div>All hydrotherapy equipment is rated for 120V, 20A (US) Consult Spec Sheet on website for Boxed Weight & Cube. .CC = Color Code / See page 155 for color options.</div><div>Operating Cap: 38 U.S. Gal.</div></div>		STANDARD	PREMIER
		<div>Includes:</div> <div><div>• 120V Systems</div><div>• Touch Control Pad</div><div>• 20-minute timer</div></div>	<div>All Standard features plus:</div> <div><div>• Ozone</div><div>• Digital Control Pad</div><div>• LED Chromatherapy</div></div>
<div><div><div><div><div></div><div>W</div></div></div><div>WHIRLPOOL</div></div></div>	<div>Includes 5 adjustable jets and 2 foot jets with pump unit indicated.</div>	<div><div>\$6,440</div><div>SL = (2188.40.11.CC)</div><div>SR = (2188.50.11.CC)</div></div>	<div><div>\$7,660</div><div>with Whirlpool heater</div><div>SL = (2188.40.15.CC)</div><div>SR = (2188.50.15.CC)</div></div>
<div><div><div><div><div></div><div>A</div></div></div><div>AIRMASSEUR®</div></div></div>	<div>Includes 34 strategically located air jets, 1hp blower w/ heater.</div>	<div><div>\$6,540</div><div>SL = (2188.40.21.CC)</div><div>SR = (2188.50.21.CC)</div></div>	<div><div>\$7,760</div><div>SL = (2188.40.25.CC)</div><div>SR = (2188.50.25.CC)</div></div>
<div><div><div><div><div></div><div>M</div></div></div><div>MICROSILK®</div></div></div>	<div>Includes 1 MicroSilk delivery port, MicroSilk unit.</div>	<div><div>\$6,300</div><div>SL = (2188.40.61.CC)</div><div>SR = (2188.50.61.CC)</div></div>	<div><div>\$7,520</div><div>SL = (2188.40.65.CC)</div><div>SR = (2188.50.65.CC)</div></div>
<div><div><div><div><div></div><div>aw</div></div></div><div>AIRMASSEUR® WHIRLPOOL</div></div></div>	<div>Includes 5 adjustable jets, 2 foot jets and 34 air jets; 1.5 hp pump; 1hp blower w/ heater. Combines all features provided with both (A) & (W) equipped Standard or Premier baths, respectively.</div>	<div><div>\$8,380</div><div>SL = (2188.40.31.CC)</div><div>SR = (2188.50.31.CC)</div></div>	<div><div>\$9,600</div><div>with Whirlpool heater</div><div>SL = (2188.40.35.CC)</div><div>SR = (2188.50.35.CC)</div></div>

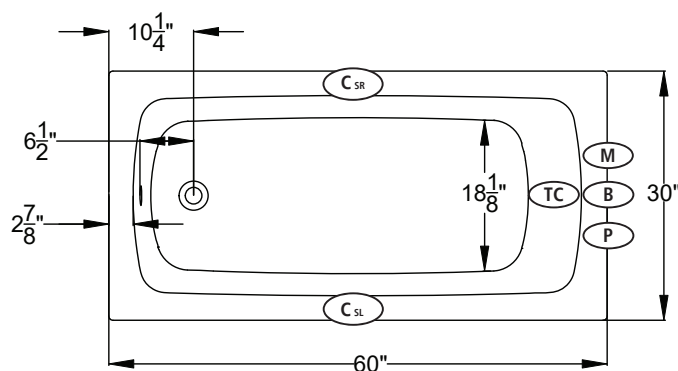

End-Access Required.
Order Removable Access Panel for Front Access.

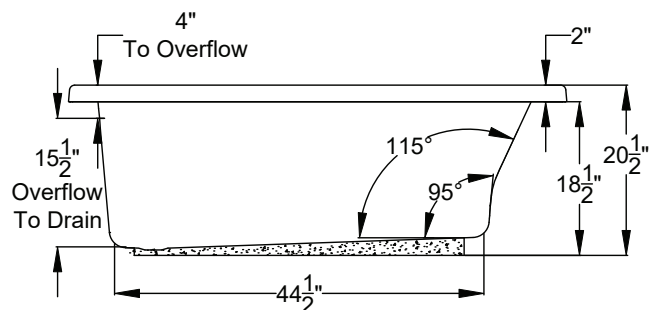

*Blower must be remote mounted on Air-Whirlpool baths.
See page 130 for remote blower mounting.

**Control Keypad will be opposite tile lip.

- (C) Control Location
- (B) Blower Location
- (M) MicroSilk[®] Unit Location
- (TC) Thermo Comfort Heating Pad Location
- (P) Whirlpool Pump Location

Bath Options

For handle information, see page 127.
For details & additional options, see page 128-130.

GH400 HANDLE - Factory installed. Accepts 2 handles. Price is per handle. If ordering 1 handle, indicate handle installation.		8709-04-0CC	\$315
JETTED NECK PILLOW - Page 128 (W) (MW)		8707-50-0CC	\$1,145
BACKSTACK™ JETS			N/A
BLUETOOTH SOUND IMMERSION SYSTEM - Page 128		8724-01-000	\$835
WATER LEVEL SENSOR - Page 128		8724-02-000	\$1,030
THERMO COMFORT - Page 129 (S) (W) (M)		8706-04-XXX	\$840
MICROSILK SHOWER WAND - Page 129	Polished Chrome	8705-55-091	\$505
	Optional Finishes	DDK-XX	\$275
DESIGNER OVERFLOW DRAIN KITS - For finish options, see Page 129.			
TILE FLANGE KIT - Page 129		8707-11-001	\$190
REMOVABLE FRONT ACCESS PANEL - Page 131 Factory Installed		8700-07-0CC	\$650