

UNDERMOUNTABLE: Yes

FAUCETRY DECK: No

TEXTURED FLOOR: No

<div> <div>(S)</div> <div><b>SOAKING</b></div> <div>Includes Level-Form™ Base</div> </div> <div> <div><b>\$2,875</b></div> <div>(2188.00.00.CC)</div> </div> <div> <div>All hydrotherapy equipment is rated for 120V, 20A (US) Consult Spec Sheet on website for Boxed Weight &amp; Cube. .CC = Color Code / See page 155 for color options.</div> <div>Operating Cap: 38 U.S. Gal.</div> </div>		STANDARD	PREMIER
<div>(W)</div> <div><b>WHIRLPOOL</b></div> <div>Includes 5 adjustable jets and 2 foot jets with pump unit indicated.</div>		<div><b>\$6,015</b></div> <div>(2188.00.11.CC)</div>	<div><b>\$7,235</b></div> <div>with Whirlpool heater</div> <div>(2188.00.15.CC)</div>
<div>(a)</div> <div><b>AIRMASSEUR<sup>®</sup></b></div> <div>Includes 34 strategically located air jets, 1hp blower w/ heater.</div>		<div><b>\$6,115</b></div> <div>(2188.00.21.CC)</div>	<div><b>\$7,335</b></div> <div>(2188.00.25.CC)</div>
<div>(m)</div> <div><b>MICROSILK<sup>®</sup></b></div> <div>Includes 1 MicroSilk delivery port, MicroSilk unit.</div>		<div><b>\$5,875</b></div> <div>(2188.00.61.CC)</div>	<div><b>\$7,095</b></div> <div>(2188.00.65.CC)</div>
<div>(aw)</div> <div><b>AIRMASSEUR<sup>®</sup> WHIRLPOOL</b></div> <div>Includes 5 adjustable jets, 2 foot jets and 34 air jets; 1.5 hp pump; 1hp blower w/ heater. Combines all features provided with both (W) &amp; (a) equipped Standard or Premier baths, respectively.</div>		<div><b>\$7,955</b></div> <div>(2188.00.31.CC)</div>	<div><b>\$9,175</b></div> <div>with Whirlpool heater</div> <div>(2188.00.35.CC)</div>
<div>(mw)</div> <div><b>MICROSILK<sup>®</sup> WHIRLPOOL</b></div>		N/A	N/A
<div>(ma)</div> <div><b>MICROSILK<sup>®</sup> AIRMASSEUR<sup>®</sup></b></div> <div>Includes 1 MicroSilk delivery port, 34 strategically located air jets; MicroSilk unit; 1hp blower w/ heater. Combines all features provided with both (a) &amp; (m) equipped Standard or Premier baths, respectively.</div>		<div><b>\$9,115</b></div> <div>(2188.00.81.CC)</div>	<div><b>\$10,335</b></div> <div>(2188.00.85.CC)</div>

Control pad can be mounted on opposing side of vessel by request.

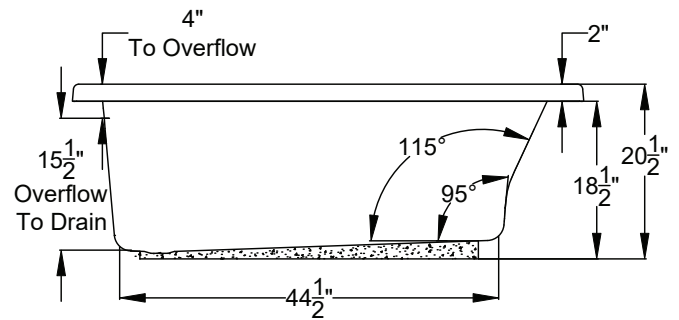
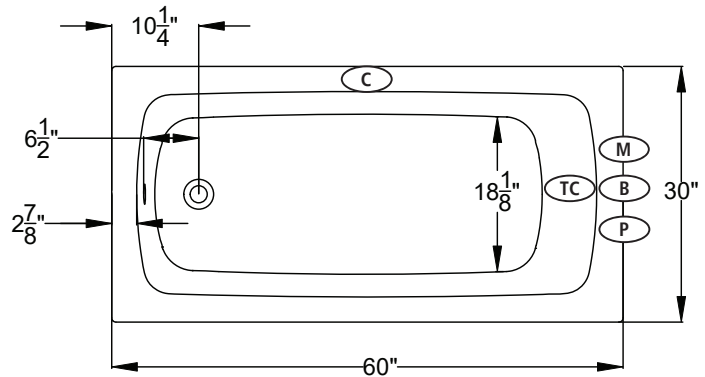

\*Blower must be remote mounted on MicroSilk®-AirMasseur® and Air-Whirlpool baths. See page 130 for remote blower mounting.

- (C) Control Location
- (B) Blower Location
- (M) MicroSilk® Unit Location
- (TC) Thermo Comfort Heating Pad Location
- (P) Whirlpool Pump Location

Bath Options		
For handle information, see page 127. For details & additional options, see page 128-130.		
GH400 HANDLE - Factory installed. Accepts 2 handles. Price is per handle. If ordering 1 handle, indicate handle installation.	8709-04-0CC	\$315
JETTED NECK PILLOW - Page 128 (W) (MW)	8707-50-0CC	\$1,145
BACKSTACK™ JETS - Page 128		N/A
BLUETOOTH SOUND IMMERSION SYSTEM - Page 128	8724-01-000	\$835
WATER LEVEL SENSOR - Page 128	8724-02-000	\$1,030
THERMO COMFORT - Page 129 (S) (W) (M)	8706-04-XXX	\$840
MICROSILK SHOWER WAND - Page 129	Polished Chrome 8705-55-091	\$505
DESIGNER OVERFLOW DRAIN KITS - For finish options, see Page 129.	Polished Chrome DDK-PC	\$160
	Optional Finishes DDK-XX	\$275
TILE FLANGE KIT - Page 129	8707-11-001	\$190
LATERAL SKIRT - Page 131	8700-01-0CC	\$1,165