

| <div><div><div>(S)</div></div><div>SOAKING</div><div>Includes Level-Form™ Base</div></div> <div><div>\$3,460</div><div>SL = (2197.40.00.CC)</div><div>SR = (2197.50.00.CC)</div></div> <div><div>All hydrotherapy equipment is rated for 120V, 20A (US)<br/>Consult Spec Sheet on website for Boxed Weight &amp; Cube.<br/>.CC = Color Code / See page 155 for color options.</div><div>Operating Cap: 40 U.S. Gal.</div></div> |  | STANDARD  | PREMIER  |
|---|--|---|--|
|   |  | <div>Includes:</div> <ul style="list-style-type: none"><li>• 120V Systems</li><li>• Touch Control Pad</li><li>• 20-minute timer</li></ul> | <div>All Standard features plus:</div> <ul style="list-style-type: none"><li>• Ozone</li><li>• Digital Control Pad</li><li>• LED Chromatherapy</li></ul> |
| <div><div><div>(W)</div></div><div>WHIRLPOOL</div></div> <div>Includes 5 adjustable jets and 2 foot jets with pump unit indicated.</div>  | <div>\$6,600</div> <div>SL = (2197.40.11.CC)</div> <div>SR = (2197.50.11.CC)</div> | <div>\$7,820</div> <div>with Whirlpool heater</div> <div>SL = (2197.40.15.CC)</div> <div>SR = (2197.50.15.CC)</div>                       |  |
| <div><div><div>(a)</div></div><div>AIRMASSEUR®</div></div> <div>Includes 42 strategically located air jets, 1hp blower w/ heater.</div>   | <div>\$6,700</div> <div>SL = (2197.40.21.CC)</div> <div>SR = (2197.50.21.CC)</div> | <div>\$7,920</div> <div>SL = (2197.40.25.CC)</div> <div>SR = (2197.50.25.CC)</div>  |  |
| <div><div><div>(m)</div></div><div>MICROSILK®</div></div> <div>Includes 1 MicroSilk delivery port, MicroSilk unit.</div>  | <div>\$6,460</div> <div>SL = (2197.40.61.CC)</div> <div>SR = (2197.50.61.CC)</div> | <div>\$7,680</div> <div>SL = (2197.40.65.CC)</div> <div>SR = (2197.50.65.CC)</div>  |  |
| <div><div><div>(aw)</div></div><div>AIRMASSEUR®<br/>WHIRLPOOL</div></div> <div>Includes 5 adjustable jets, 2 foot jets and 42 air jets; 1.5 hp pump; 1hp blower w/ heater. Combines all features provided with both (a) &amp; (W) equipped Standard or Premier baths, respectively.</div>   | <div>\$8,540</div> <div>SL = (2197.40.31.CC)</div> <div>SR = (2197.50.31.CC)</div> | <div>\$9,760</div> <div>with Whirlpool heater</div> <div>SL = (2197.40.35.CC)</div> <div>SR = (2197.50.35.CC)</div>                       |  |

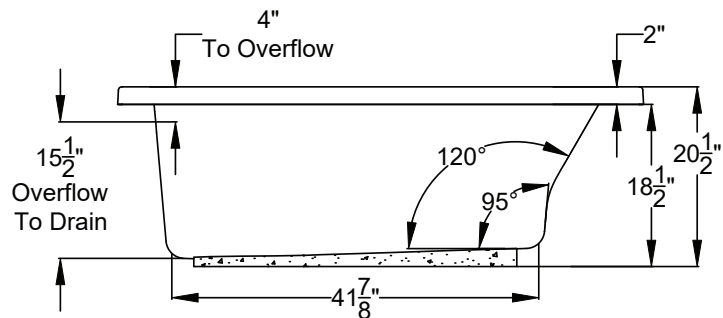

End-Access Required.  
Order Removable Access Panel for Front Access.

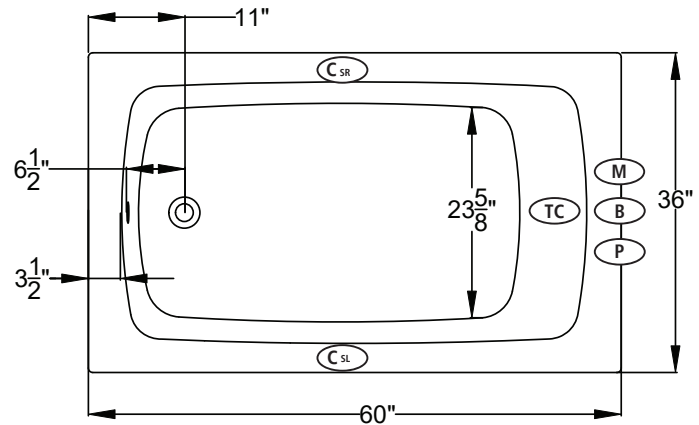

\*Blower must be remote mounted on Air-Whirlpool baths.  
See page 130 for remote blower mounting.

- (C)** Control Location
- (M)** MicroSilk<sup>®</sup> Unit Location
- (P)** Whirlpool Pump Location
- (B)** Blower Location
- (TC)** Thermo Comfort Heating Pad Location

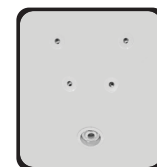

1 set of  
Back-Stack™ jets  
on **(W)**  
(Optional)

### Bath Options

For handle information, see page 127.  
For details & additional options, see page 128-130.

|  |                   |             |         |
|--|-------------------|-------------|---------|
| <b>GH400 HANDLE</b> - Factory installed.<br>Accepts 2 handles. Price is per handle.<br>If ordering 1 handle, indicate handle installation. |                   | 8709-04-0CC | \$315   |
| <b>JETTED NECK PILLOW</b> - Page 128 <b>(W)</b>  |                   | 8707-50-0CC | \$1,145 |
| <b>BACKSTACK™ JETS</b> - Page 128 <b>(W)</b>   |                   | 8707-30-001 | \$930   |
| <b>BLUETOOTH SOUND IMMERSION SYSTEM</b> - Page 128   |                   | 8724-01-000 | \$835   |
| <b>WATER LEVEL SENSOR</b> - Page 128   |                   | 8724-02-000 | \$1,030 |
| <b>THERMO COMFORT</b> - Page 129 <b>(S) (W) (m)</b>  |                   | 8706-04-XXX | \$840   |
| <b>MICROSILK SHOWER WAND</b> - Page 129  | Polished Chrome   | 8705-55-091 | \$505   |
|  | Optional Finishes | DDK-XX      | \$275   |
| <b>DESIGNER OVERFLOW DRAIN KITS</b> -<br>For finish options, see Page 129.   |                   | DDK-PC      | \$160   |
| <b>TILE FLANGE KIT</b> - Page 129  |                   | 8707-11-001 | \$190   |
| <b>REMOVABLE FRONT ACCESS PANEL</b> - Page 131<br>Factory Installed  |                   | 8700-07-0CC | \$650   |