

UNDERMOUNTABLE: No

FAUCETRY DECK: No

TEXTURED FLOOR: No

<div><div><div>S</div></div></div> <div>SOAKING</div> <div>Includes Level-Form™ Base</div>		<div>\$3,460</div> <div>SL = (2197.40.00.CC)</div> <div>SR = (2197.50.00.CC)</div>	<div>All hydrotherapy equipment is rated for 120V, 20A (US) Consult Spec Sheet on website for Boxed Weight & Cube. .CC = Color Code / See page 155 for color options.</div> <div>Operating Cap: 40 U.S. Gal.</div>	STANDARD	PREMIER
				<div>Includes:</div> <div><div>• 120V Systems</div><div>• Touch Control Pad</div><div>• 20-minute timer</div></div>	<div>All Standard features plus:</div> <div><div>• Ozone</div><div>• Digital Control Pad</div><div>• LED Chromatherapy</div></div>
<div><div>W</div></div> <div>WHIRLPOOL</div>	Includes 5 adjustable jets and 2 foot jets with pump unit indicated.			<div>\$6,600</div> <div>SL = (2197.40.11.CC)</div> <div>SR = (2197.50.11.CC)</div>	<div>\$7,820</div> <div>with Whirlpool heater</div> <div>SL = (2197.40.15.CC)</div> <div>SR = (2197.50.15.CC)</div>
<div><div>a</div></div> <div>AIRMASSEUR®</div>	Includes 42 strategically located air jets, 1hp blower w/ heater.			<div>\$6,700</div> <div>SL = (2197.40.21.CC)</div> <div>SR = (2197.50.21.CC)</div>	<div>\$7,920</div> <div>SL = (2197.40.25.CC)</div> <div>SR = (2197.50.25.CC)</div>
<div><div>m</div></div> <div>MICROSILK®</div>	Includes 1 MicroSilk delivery port, MicroSilk unit.			<div>\$6,460</div> <div>SL = (2197.40.61.CC)</div> <div>SR = (2197.50.61.CC)</div>	<div>\$7,680</div> <div>SL = (2197.40.65.CC)</div> <div>SR = (2197.50.65.CC)</div>
<div><div>aw</div></div> <div>AIRMASSEUR® WHIRLPOOL</div>	Includes 5 adjustable jets, 2 foot jets and 42 air jets; 1.5 hp pump; 1hp blower w/ heater. Combines all features provided with both (a) & (w) equipped Standard or Premier baths, respectively.			<div>\$8,540</div> <div>SL = (2197.40.31.CC)</div> <div>SR = (2197.50.31.CC)</div>	<div>\$9,760</div> <div>with Whirlpool heater</div> <div>SL = (2197.40.35.CC)</div> <div>SR = (2197.50.35.CC)</div>

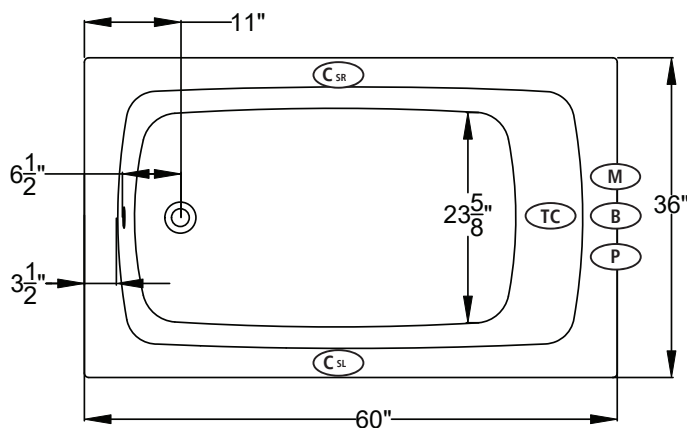

End-Access Required.
Order Removable Access Panel for Front Access.

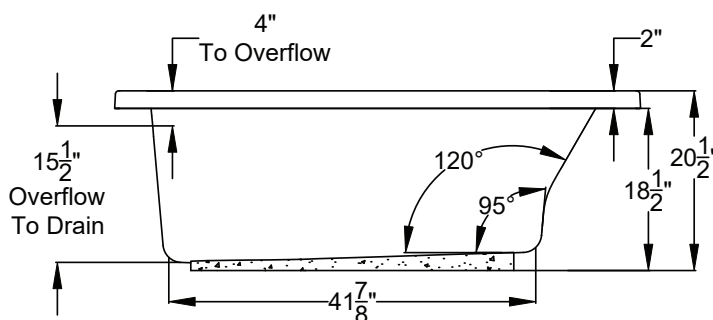

*Blower must be remote mounted on Air-Whirlpool baths.
See page 130 for remote blower mounting.

- (C)** Control Location
- (M)** MicroSilk[®] Unit Location
- (P)** Whirlpool Pump Location
- (B)** Blower Location
- (TC)** Thermo Comfort Heating Pad Location

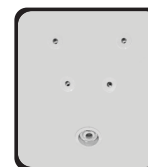

1 set of
Back-Stack™ jets
on **(W)**
(Optional)

Bath Options

For handle information, see page 127.
For details & additional options, see page 128-130.

GH400 HANDLE - Factory installed. Accepts 2 handles. Price is per handle. If ordering 1 handle, indicate handle installation.		8709-04-0CC	\$315
JETTED NECK PILLOW - Page 128 (W)		8707-50-0CC	\$1,145
BACKSTACK™ JETS - Page 128 (W)		8707-30-001	\$930
BLUETOOTH SOUND IMMERSION SYSTEM - Page 128		8724-01-000	\$835
WATER LEVEL SENSOR - Page 128		8724-02-000	\$1,030
THERMO COMFORT - Page 129 (S) (W) (m)		8706-04-XXX	\$840
MICROSILK SHOWER WAND - Page 129	Polished Chrome	8705-55-091	\$505
	Optional Finishes	DDK-XX	\$275
DESIGNER OVERFLOW DRAIN KITS - For finish options, see Page 129.		DDK-PC	\$160
TILE FLANGE KIT - Page 129		8707-11-001	\$190
REMOVABLE FRONT ACCESS PANEL - Page 131 Factory Installed		8700-07-0CC	\$650