

UNDERMOUNTABLE: Yes

FAUCETRY DECK: No

TEXTURED FLOOR: No

| <div><div><div>(S)</div></div><div>SOAKING</div><div>Includes Level-Form™ Base</div></div> <div><div>\$3,100</div><div>(2187.00.00.CC)</div></div> <div><div>All hydrotherapy equipment is rated for 120V, 20A (US)<br/>Consult Spec Sheet on website for Boxed Weight &amp; Cube.<br/>.CC = Color Code / See page 155 for color options.</div><div>Operating Cap: 48 U.S. Gal.</div></div> |   | STANDARD  | PREMIER  |
|---|---|---|--|
|   |   | <div>Includes:</div> <div><div>• 120V Systems</div><div>• Touch Control Pad</div><div>• 20-minute timer</div></div> | <div>All Standard features plus:</div> <div><div>• Ozone</div><div>• Digital Control Pad</div><div>• LED Chromatherapy</div></div> |
| <div><div>(W)</div><div>WHIRLPOOL</div></div>   | Includes 5 adjustable jets and 2 foot jets with pump unit indicated.  | <div>\$6,240</div> <div>(2187.00.11.CC)</div>   | <div>\$7,460</div> <div>with Whirlpool heater</div> <div>(2187.00.15.CC)</div>   |
| <div><div>(a)</div><div>AIRMASSEUR®</div></div>   | Includes 44 strategically located air jets, 1hp blower w/ heater.   | <div>\$6,340</div> <div>(2187.00.21.CC)</div>   | <div>\$7,560</div> <div>(2187.00.25.CC)</div>  |
| <div><div>(m)</div><div>MICROSILK®</div></div>  | Includes 1 MicroSilk delivery port, MicroSilk unit.   | <div>\$6,100</div> <div>(2187.00.61.CC)</div>   | <div>\$7,320</div> <div>(2187.00.65.CC)</div>  |
| <div><div>(aw)</div><div>AIRMASSEUR® WHIRLPOOL</div></div>  | Includes 5 adjustable jets, 2 foot jets and 44 air jets; 1.5 hp pump; 1hp blower w/ heater. Combines all features provided with both (W) & (a) equipped Standard or Premier baths, respectively.                  | <div>\$8,180</div> <div>(2187.00.31.CC)</div>   | <div>\$9,400</div> <div>with Whirlpool heater</div> <div>(2187.00.35.CC)</div>   |
| <div><div>(mw)</div><div>MICROSILK® WHIRLPOOL</div></div>   | Includes 5 adjustable jets, 2 foot jets and 1 MicroSilk delivery port; MicroSilk unit; 1.5 hp pump. Combines all features provided with both (W) & (m) equipped Standard or Premier baths, respectively.          | <div>\$9,235</div> <div>(2187.00.71.CC)</div>   | <div>\$10,455</div> <div>with Whirlpool heater</div> <div>(2187.00.75.CC)</div>  |
| <div><div>(ma)</div><div>MICROSILK® AIRMASSEUR®</div></div>   | Includes 1 MicroSilk delivery port, 44 strategically located air jets; MicroSilk unit; 1hp blower w/ heater. Combines all features provided with both (a) & (m) equipped Standard or Premier baths, respectively. | <div>\$9,340</div> <div>(2187.00.81.CC)</div>   | <div>\$10,560</div> <div>(2187.00.85.CC)</div>   |

Control pad can be mounted on opposing side of vessel by request.

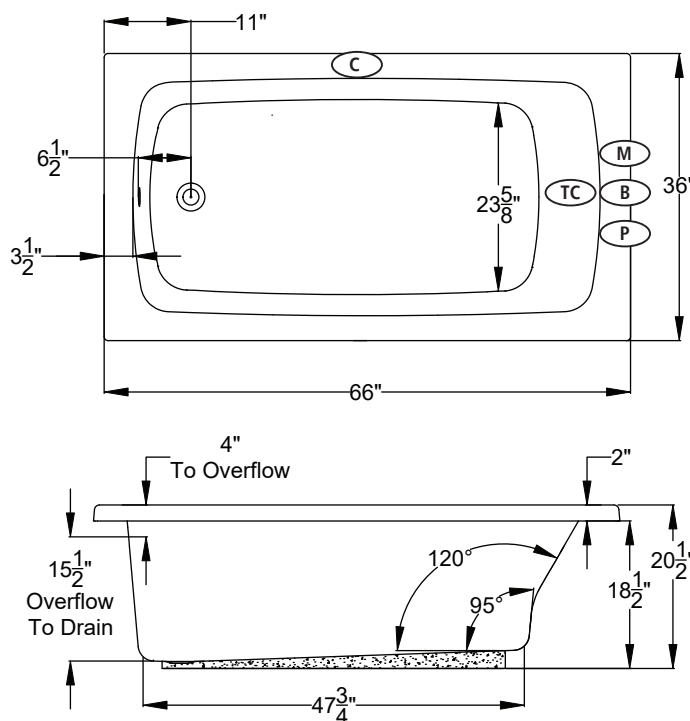

**NOTE:** (mw) equipment may extend beyond the perimeter of the bath. Consult factory for details.

## Bath Options

For handle information, see page 127.  
For details & additional options, see page 128-130.

|  |                   |             |         |
|--|-------------------|-------------|---------|
| <b>GH400 HANDLE</b> - Factory installed.<br>Accepts 2 handles. Price is per handle.<br>If ordering 1 handle, indicate handle installation. |                   | 8709-04-0CC | \$315   |
| <b>JETTED NECK PILLOW</b> - Page 128 (W) (aw) (mw)   |                   | 8707-50-0CC | \$1,145 |
| <b>BACKSTACK™ JETS</b> - Page 128 (W) (mw)   |                   | 8707-30-001 | \$930   |
| <b>BLUETOOTH SOUND IMMERSION SYSTEM</b> - Page 128   |                   | 8724-01-000 | \$835   |
| <b>WATER LEVEL SENSOR</b> - Page 128   |                   | 8724-02-000 | \$1,030 |
| <b>THERMO COMFORT</b> - Page 129 (S) (W) (m) (mw)  |                   | 8706-04-XXX | \$840   |
| <b>MICROSILK SHOWER WAND</b> - Page 129  | Polished Chrome   | 8705-55-091 | \$505   |
|  | Polished Chrome   | DDK-PC      | \$160   |
| <b>DESIGNER OVERFLOW DRAIN KITS</b> -<br>For finish options, see Page 129.   | Optional Finishes | DDK-XX      | \$275   |
|  |                   |             |         |
| <b>TILE FLANGE KIT</b> - Page 129  |                   | 8707-11-001 | \$190   |
| <b>LATERAL SKIRT</b> - Page 131  |                   | 8700-02-0CC | \$1,165 |

\*Blower must be remote mounted on MicroSilk®-AirMasseur® and Air-Whirlpool baths. See page 130 for remote blower mounting.

- (C) Control Location
- (M) MicroSilk® Unit Location
- (P) Whirlpool Pump Location
- (B) Blower Location
- (TC) Thermo Comfort Heating Pad Location

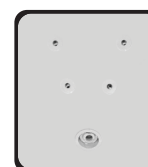

1 set of  
Back-Stack™ jets  
on (W) (mw)  
(Optional)