

UNDERMOUNTABLE: No

FAUCETRY DECK: Yes

TEXTURED FLOOR: No

(S)

SOAKING

Includes Level-Form™ Base

\$3,535
(2167.00.00.CC)

All hydrotherapy equipment is rated for 120V, 20A (US)
Consult Spec Sheet on website for Boxed Weight & Cube.
.CC = Color Code / See page 155 for color options.

Operating Cap: 66 U.S. Gal.

STANDARD

Includes:
• 120V Systems
• Touch Control Pad
• 20-minute timer

PREMIER

All Standard features plus:
• Ozone
• Digital Control Pad
• LED Chromotherapy

(W)
WHIRLPOOL

Includes 6 adjustable jets and 2 sets of 4 BackStack™ jets with pump unit indicated.

\$8,275
(2167.00.11.CC)

\$9,495
with Whirlpool heater
(2167.00.15.CC)

(a)
AIRMASSEUR®

Includes 48 strategically located air jets, 1hp blower w/ heater.

\$8,375
(2167.00.21.CC)

\$9,595
(2167.00.25.CC)

(m)
MICROSILK®

Includes 1 MicroSilk delivery port, MicroSilk unit.

\$8,135
(2167.00.61.CC)

\$9,355
(2167.00.65.CC)

(aw)
AIRMASSEUR® WHIRLPOOL

Includes 6 adjustable jets, 2 sets of 4 BackStack™ jets and 48 air jets; 1.5 hp pump; 1hp blower w/ heater. Combines all features provided with both (W) & (a) equipped Standard or Premier baths, respectively.

\$10,215
(2167.00.31.CC)

\$11,435
with Whirlpool heater
(2167.00.35.CC)

(mw)
MICROSILK® WHIRLPOOL

Includes 6 adjustable jets, 2 sets of 4 BackStack™ jets and 1 MicroSilk delivery port; MicroSilk unit; 1.5 hp pump. Combines all features provided with both (W) & (m) equipped Standard or Premier baths, respectively.

\$11,270
(2167.00.71.CC)

\$12,490
with Whirlpool heater
(2167.00.75.CC)

(ma)
MICROSILK® AIRMASSEUR®

Includes 1 MicroSilk delivery port, 48 strategically located air jets; MicroSilk unit; 1hp blower w/ heater. Combines all features provided with both (a) & (m) equipped Standard or Premier baths, respectively.

\$11,375
(2167.00.81.CC)

\$12,595
(2167.00.85.CC)

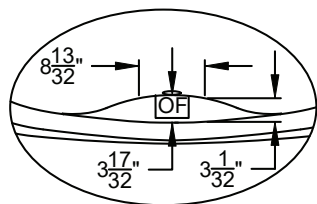

Faucetry Deck
Flat Dimensions

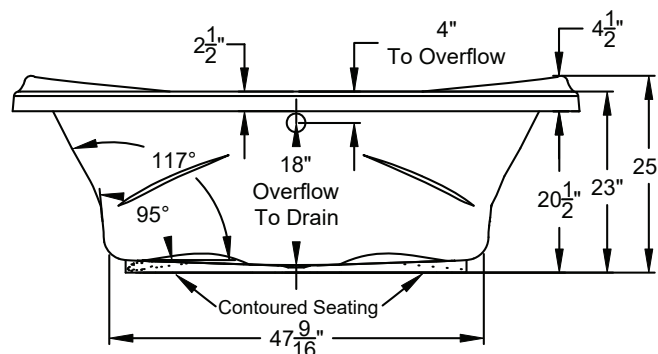
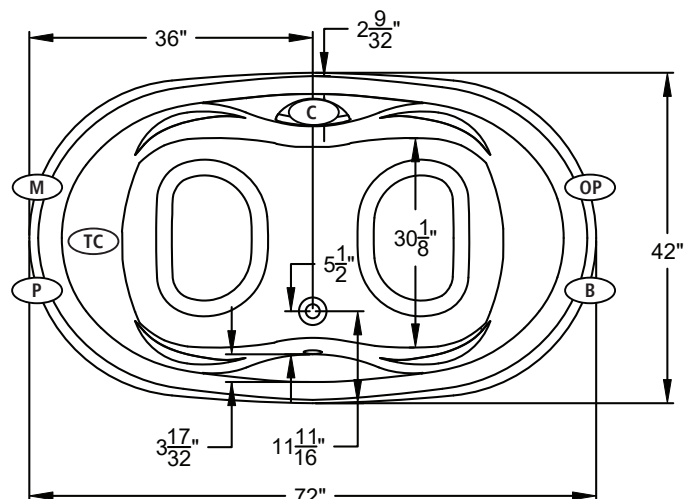

- (C) Control Location
- (M) MicroSilk® Unit Location
- (P) Whirlpool Pump Location
- (B) Blower Location
- (TC) Thermo Comfort Heating Pad Location
- (OP) Optional pump location available on (W) only. Please designate pump location. On (mw) the pump will be in this location.

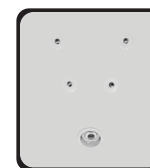

2 sets of
BackStack™ jets
on (W) (aw) (mw)
(Included)

Bath Options

For handle information, see page 127.
For details & additional options, see page 128-130.

ACRYLIC HANDLES - Factory installed.		Included
JETTED NECK PILLOW - Page 128 (W) (aw) (mw)	8707-50-0CC	\$1,145
BACKSTACK™ JETS - Page 128 (W) (aw) (mw)		Included
BLUETOOTH SOUND IMMERSION SYSTEM - Page 128	8724-01-000	\$835
WATER LEVEL SENSOR - Page 128	8724-02-000	\$1,030
THERMO COMFORT - Page 129	8706-04-XXX	\$840
MICROSILK SHOWER WAND - Page 129	Polished Chrome 8705-55-091	\$505
DESIGNER OVERFLOW DRAIN KITS - For finish options, see Page 129.	Polished Chrome DDK-PC	\$160
	Optional Finishes DDK-XX	\$275