

UNDERMOUNTABLE: No

FAUCETRY DECK: No

TEXTURED FLOOR: Yes

<div> <div>(S)</div> <b>SOAKING</b> Includes Level-Form™ Base         </div> <div> <b>\$6,580</b> (2157.09.00.CC)         </div> <div> <small>All hydrotherapy equipment is rated for 120V, 20A (US) Consult Spec Sheet on website for Boxed Weight &amp; Cube. .CC = Color Code / See page 155 for color options.</small>  <b>Operating Cap: 52 U.S. Gal.</b> </div>		STANDARD	PREMIER
<div>(W)</div> <b>WHIRLPOOL</b> Includes 5 adjustable jets and 1 set of 4 BackStack™ jets with pump unit indicated.		<b>\$10,420</b> (2157.09.11.CC)	<b>\$11,640</b> with Whirlpool heater (2157.09.15.CC)
<div>(a)</div> <b>AIRMASSEUR®</b> Includes 46 strategically located air jets, 1hp blower w/ heater.		<b>\$9,820</b> (2157.09.21.CC)	<b>\$11,040</b> (2157.09.25.CC)
<div>(m)</div> <b>MICROSILK®</b> Includes 1 MicroSilk delivery port, MicroSilk unit.		<b>\$10,280</b> (2157.09.61.CC)	<b>\$11,500</b> (2157.09.65.CC)
<div>(aw)</div> <b>AIRMASSEUR® WHIRLPOOL</b> Includes 5 adjustable jets, 1 set of 4 BackStack™ jets and 46 air jets; 1.5 hp pump; 1hp blower w/ heater. Combines all features provided with both (W) & (a) equipped Standard or Premier baths, respectively.		<b>\$12,360</b> (2157.09.31.CC)	<b>\$13,580</b> with Whirlpool heater (2157.09.35.CC)
<div>(ma)</div> <b>MICROSILK® AIRMASSEUR®</b> Includes 1 MicroSilk delivery port, 46 strategically located air jets; MicroSilk unit; 1hp blower w/ heater. Combines all features provided with both (a) & (m) equipped Standard or Premier baths, respectively.		<b>\$13,520</b> (2157.09.81.CC)	<b>\$14,740</b> (2157.09.85.CC)

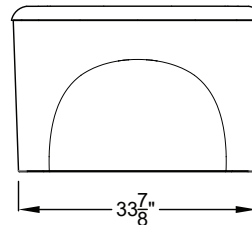
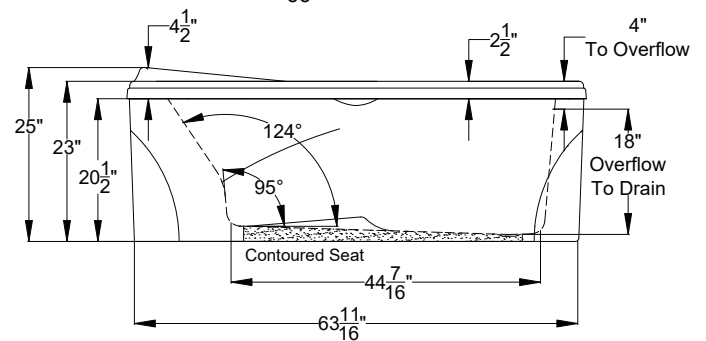
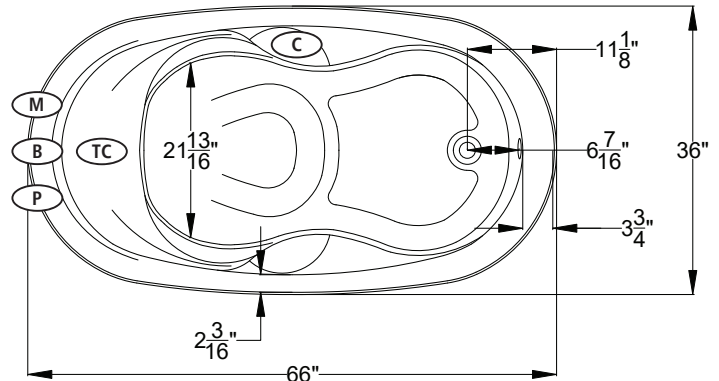

\*Blower must be remote mounted on MicroSilk®-AirMasseur® and Air-Whirlpool baths. See page 130 for remote blower mounting.

- (C) Control Location
- (M) MicroSilk® Unit Location
- (P) Whirlpool Pump Location
- (B) Blower Location
- (TC) Thermo Comfort Heating Pad Location

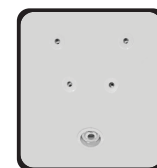

1 set of  
BackStack™ jets  
on (W) (aw)  
(Included)

## Bath Options

For handle information, see page 127.  
For details & additional options, see page 128-130.

ACRYLIC HANDLES - Factory installed.		Included
ACRYLIC EQUIPMENT CABINET - Page 129		N/A
BLUETOOTH SOUND IMMERSION SYSTEM - Page 128	8724-01-000	\$835
WATER LEVEL SENSOR - Page 128	8724-02-000	\$1,030
THERMO COMFORT - Page 129 (S) (W) (m)	8706-04-XXX	\$840
MICROSILK SHOWER WAND - Page 129	Polished Chrome 8705-55-091	\$505
DESIGNER OVERFLOW DRAIN KITS - For finish options, see Page 129.	Polished Chrome DDK-PC	\$160
	Optional Finishes DDK-XX	\$275