

UNDERMOUNTABLE: No

FAUCETRY DECK: No

TEXTURED FLOOR: Yes

<div> <div>(S)</div> <div>SOAKING</div> <div>Includes Level-Form™ Base</div> </div> <div> <div>\$3,580</div> <div>(2157.00.00.CC)</div> </div> <div> <div>All hydrotherapy equipment is rated for 120V, 20A (US) Consult Spec Sheet on website for Boxed Weight & Cube. .CC = Color Code / See page 155 for color options.</div> <div>Operating Cap: 52 U.S. Gal.</div> </div>		STANDARD	PREMIER
<div>(W)</div> <div>WHIRLPOOL</div> <div>Includes 5 adjustable jets and 1 set of 4 BackStack™ jets with pump unit indicated.</div>		<div>\$7,520</div> <div>(2157.00.11.CC)</div>	<div>\$8,740</div> <div>with Whirlpool heater</div> <div>(2157.00.15.CC)</div>
<div>(a)</div> <div>AIRMASSEUR®</div> <div>Includes 46 strategically located air jets, 1hp blower w/ heater.</div>		<div>\$6,820</div> <div>(2157.00.21.CC)</div>	<div>\$8,040</div> <div>(2157.00.25.CC)</div>
<div>(m)</div> <div>MICROSILK®</div> <div>Includes 1 MicroSilk delivery port, MicroSilk unit.</div>		<div>\$6,580</div> <div>(2157.00.61.CC)</div>	<div>\$7,800</div> <div>(2157.00.65.CC)</div>
<div>(aw)</div> <div>AIRMASSEUR® WHIRLPOOL</div> <div>Includes 5 adjustable jets, 1 set of 4 BackStack™ jets and 46 air jets; 1.5 hp pump; 1hp blower w/ heater. Combines all features provided with both (W) & (a) equipped Standard or Premier baths, respectively.</div>		<div>\$9,460</div> <div>(2157.00.31.CC)</div>	<div>\$10,680</div> <div>with Whirlpool heater</div> <div>(2157.00.35.CC)</div>
<div>(mw)</div> <div>MICROSILK® WHIRLPOOL</div> <div>Includes 5 adjustable jets, 1 set of 4 BackStack™ jets and 1 MicroSilk delivery port; MicroSilk unit; 1.5 hp pump. Combines all features provided with both (W) & (m) equipped Standard or Premier baths, respectively.</div>		<div>\$10,515</div> <div>(2157.00.71.CC)</div>	<div>\$11,735</div> <div>with Whirlpool heater</div> <div>(2157.00.75.CC)</div>
<div>(ma)</div> <div>MICROSILK® AIRMASSEUR®</div> <div>Includes 1 MicroSilk delivery port, 46 strategically located air jets; MicroSilk unit; 1hp blower w/ heater. Combines all features provided with both (a) & (m) equipped Standard or Premier baths, respectively.</div>		<div>\$9,820</div> <div>(2157.00.81.CC)</div>	<div>\$11,040</div> <div>(2157.00.85.CC)</div>

Control pad can be mounted on opposing side of vessel by request.

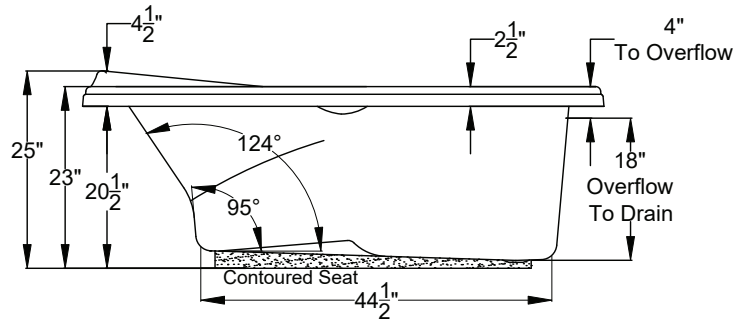
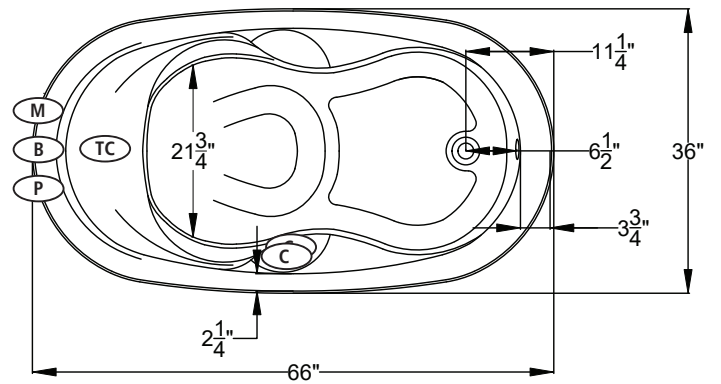

*Blower must be remote mounted on MicroSilk®-AirMasseur® and Air-Whirlpool baths. See page 130 for remote blower mounting.

- (C) Control Location
- (M) MicroSilk® Unit Location
- (P) Whirlpool Pump Location
- (B) Blower Location
- (TC) Thermo Comfort Heating Pad Location

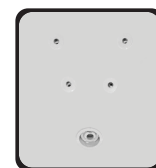

1 set of BackStack™ jets on (W) (aw) (mw) (Included)

Bath Options		For handle information, see page 127. For details & additional options, see page 128-130.	
ACRYLIC HANDLES - Factory installed.			Included
JETTED NECK PILLOW - Page 128	(W) (aw) (mw)	8707-50-0CC	\$1,145
BACKSTACK™ JETS - Page 128	(W) (aw) (mw)		Included
BLUETOOTH SOUND IMMERSION SYSTEM - Page 128		8724-01-000	\$835
WATER LEVEL SENSOR - Page 128		8724-02-000	\$1,030
THERMO COMFORT - Page 129	(S) (W) (m) (mw)	8706-04-XXX	\$840
MICROSILK SHOWER WAND - Page 129	Polished Chrome	8705-55-091	\$505
DESIGNER OVERFLOW DRAIN KITS - For finish options, see Page 129.	Polished Chrome	DDK-PC	\$160
	Optional Finishes	DDK-XX	\$275