

<div> <div>(S)</div> <div>SOAKING</div> <div>Includes Level-Form™ Base</div> </div> <div> <div>\$3,100</div> <div>(2149.00.00.CC)</div> </div> <div> <div>All hydrotherapy equipment is rated for 120V, 20A (US) Consult Spec Sheet on website for Boxed Weight & Cube. .CC = Color Code / See page 155 for color options.</div> <div>Operating Cap: 40 U.S. Gal.</div> </div>		STANDARD	PREMIER
<div>(W)</div> <div>WHIRLPOOL</div> <div>Includes 6 adjustable jets with pump unit indicated.</div>		<div>\$6,240</div> <div>(2149.00.11.CC)</div>	<div>\$7,460</div> <div>with Whirlpool heater</div> <div>(2149.00.15.CC)</div>
<div>(a)</div> <div>AIRMASSEUR[®]</div> <div>Includes 44 strategically located air jets, 1hp blower w/ heater.</div>		<div>\$6,340</div> <div>(2149.00.21.CC)</div>	<div>\$7,560</div> <div>(2149.00.25.CC)</div>
<div>(m)</div> <div>MICROSILK[®]</div> <div>Includes 1 MicroSilk delivery port, MicroSilk unit.</div>		<div>\$6,100</div> <div>(2149.00.61.CC)</div>	<div>\$7,320</div> <div>(2149.00.65.CC)</div>
<div>(aw)</div> <div>AIRMASSEUR[®] WHIRLPOOL</div> <div>Includes 6 adjustable jets and 44 air jets; 1.5 hp pump; 1hp blower w/ heater. Combines all features provided with both (W) & (a) equipped Standard or Premier baths, respectively.</div>		<div>\$8,180</div> <div>(2149.00.31.CC)</div>	<div>\$9,400</div> <div>with Whirlpool heater</div> <div>(2149.00.35.CC)</div>
<div>(mw)</div> <div>MICROSILK[®] WHIRLPOOL</div> <div>Includes 6 adjustable jets and 1 MicroSilk delivery port; MicroSilk unit; 1.5 hp pump. Combines all features provided with both (W) & (m) equipped Standard or Premier baths, respectively.</div>		<div>\$9,235</div> <div>(2149.00.71.CC)</div>	<div>\$10,455</div> <div>with Whirlpool heater</div> <div>(2149.00.75.CC)</div>
<div>(ma)</div> <div>MICROSILK[®] AIRMASSEUR[®]</div> <div>Includes 1 MicroSilk delivery port, 44 strategically located air jets; MicroSilk unit; 1hp blower w/ heater. Combines all features provided with both (a) & (m) equipped Standard or Premier baths, respectively.</div>		<div>\$9,340</div> <div>(2149.00.81.CC)</div>	<div>\$10,560</div> <div>(2149.00.85.CC)</div>

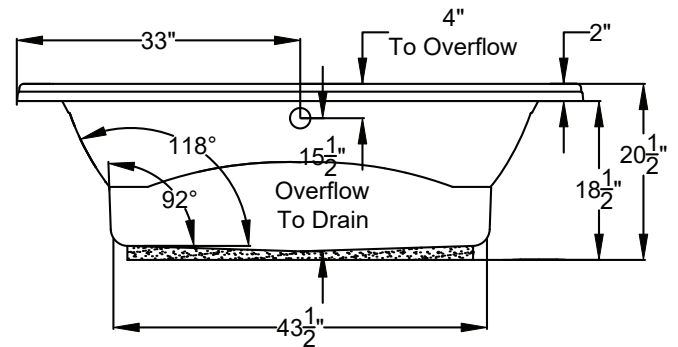

- (C)** Control Location
- (M)** MicroSilk[®] Unit Location
- (P)** Whirlpool Pump Location
- (B)** Blower Location
- (TC)** Thermo Comfort Heating Pad Location
- (OP)** Optional pump location available on **(W)** only. Please designate pump location.

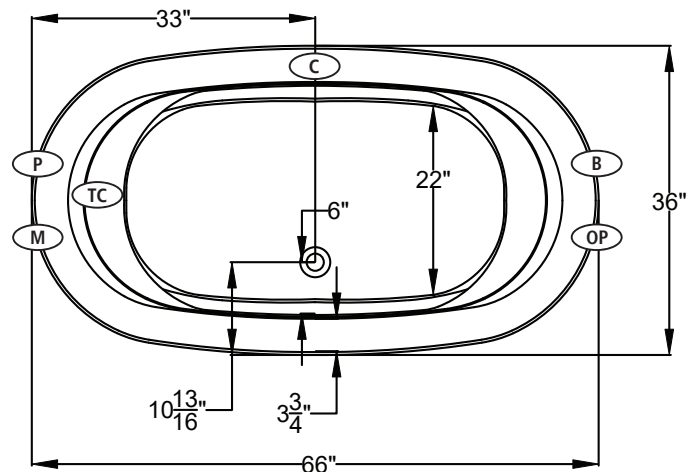
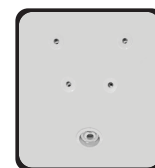

1 set of
Back-Stack™ jets
on **(W)** **(mw)**
(Optional)

NOTE: **(mw)** equipment may extend beyond the perimeter of the bath. Consult factory for details.

Bath Options

For handle information, see page 127.

For details & additional options, see page 128-130.

GH20 HANDLE - Factory installed. Accepts 1 handle across from overflow.		8709-24-0CC	\$240
JETTED NECK PILLOW - Page 128 (W) (aw) (mw)		8707-50-0CC	\$1,145
BACKSTACK™ JETS - Page 128 (W) (mw)		8707-30-001	\$930
BLUETOOTH SOUND IMMERSION SYSTEM - Page 128		8724-01-000	\$835
WATER LEVEL SENSOR - Page 128		8724-02-000	\$1,030
THERMO COMFORT - Page 129		8706-04-XXX	\$840
MICROSILK SHOWER WAND - Page 129	Polished Chrome	8705-55-091	\$505
	Optional Finishes	DDK-XX	\$275
DESIGNER OVERFLOW DRAIN KITS - For finish options, see Page 129.		DDK-PC	\$160
		DDK-XX	\$275