

UNDERMOUNTABLE: Yes

FAUCETRY DECK: No

TEXTURED FLOOR: Yes

<p>(S) SOAKING Includes Level-Form™ Base</p>	<p>\$2,795 (3168.00.00.CC)</p> <p>All hydrotherapy equipment is rated for 120V, 20A (US) Consult Spec Sheet on website for Boxed Weight & Cube. .CC = Color Code / See page 155 for color options. Operating Cap: 52 U.S. Gal.</p>	
<p>(W) WHIRLPOOL</p>	<ul style="list-style-type: none"> 1 hp, 120V pump - Air on/off control Includes 5 adjustable jets 	<p>\$4,090 (3168.00.17.CC)</p>
<p>(a) AIRMASSEUR[®]</p>	<ul style="list-style-type: none"> ¾ hp, 120V blower - Air on/off control with 20-minute timer & purge 38 strategically located air jets 20-minute timer with purge cycle 	<p>\$4,620 (3168.00.27.CC)</p>
<p>(m) MICROSILK[®]</p>	<ul style="list-style-type: none"> 120V MicroSilk[®] System - Air on/off control with a 20-minute timer Includes 1 MicroSilk[®] delivery port 	<p>\$4,695 (3168.00.67.CC)</p>

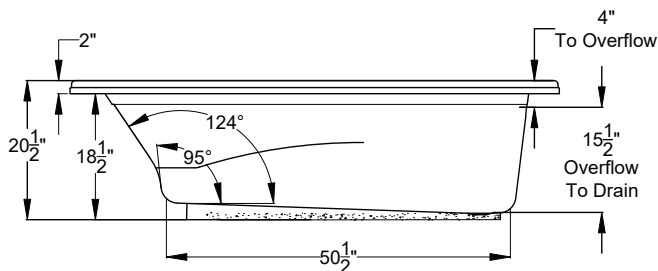
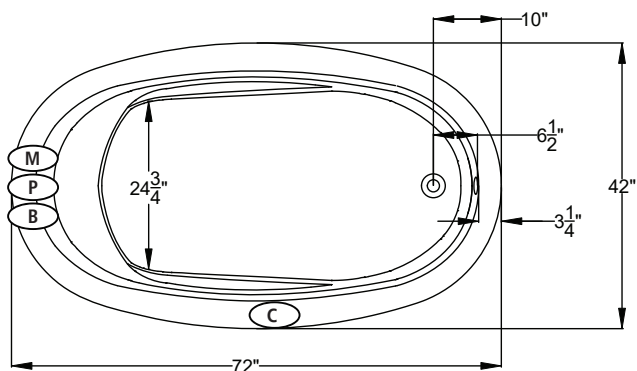

Bath Options

For handle information, see page 127.
For additional options and details, see page 128-130.

LATERAL SKIRT - Page 131 Field Installed	WT	N/A	N/A
	BQ	N/A	N/A
GH20 GRIP HANDLES	Factory Installed. Accepts 2 handles. Price is per handle. If 1 handle is desired, indicate installation location.		
AUTOMATIC OZONE SYSTEM - Page 128	(W) (m)	OZONE-100	\$700
	(a)	OZONE-200	\$700
STAINLESS STEEL HEATER - Page 128	(W)	8706-11-106	\$455
OVERFLOW DRAIN ASSEMBLY - Page 129 (Group BE)	WT	8705-15-001	\$275
	BQ	8705-15-040	\$275
	Polished Chrome	8705-15-091	\$160
	Polished Nickel	8705-15-092	\$275
	Brushed Nickel	8705-15-095	\$275
MICROSILK SHOWER WAND - Page 129	Polished Chrome	8705-55-091	\$505
TILE FLANGE KIT - Page 129	8707-11-001		

(M) MicroSilk[®] Unit Location
(B) Blower Location

(P) Pump Location
(C) Control Location