

UNDERMOUNTABLE: Yes

FAUCETRY DECK: No

TEXTURED FLOOR: Yes

<div><div><div><div><div><div></div><div>(S)</div></div></div><div><div></div><div>SOAKING</div></div></div></div><div>Includes Level-Form™ Base</div></div> <div><div><div>\$3,210</div><div>(2147.00.00.CC)</div></div></div> <div><div>All hydrotherapy equipment is rated for 120V, 20A (US) Consult Spec Sheet on website for Boxed Weight & Cube. .CC = Color Code / See page 155 for color options.</div><div>Operating Cap: 43 U.S. Gal.</div></div>		STANDARD		PREMIER	
Includes:		All Standard features plus:			
<div><div><div>• 120V Systems</div><div>• Touch Control Pad</div><div>• 20-minute timer</div></div></div>		<div><div><div>• Ozone</div><div>• Digital Control Pad</div><div>• LED Chromotherapy</div></div></div>			
<div><div><div><div><div></div><div>(W)</div></div></div><div><div></div><div>WHIRLPOOL</div></div></div></div>		N/A	N/A		
<div><div><div><div><div></div><div>(a)</div></div></div><div><div></div><div>AIRMASSEUR®</div></div></div></div>	Includes 48 strategically located air jets, 1hp blower w/ heater.	\$6,450 (2147.00.21.CC)	\$7,670 (2147.00.25.CC)		
<div><div><div><div><div></div><div>(m)</div></div></div><div><div></div><div>MICROSILK®</div></div></div></div>	Includes 1 MicroSilk delivery port, MicroSilk unit.	\$6,210 (2147.00.61.CC)	\$7,430 (2147.00.65.CC)		
<div><div><div><div><div></div><div>(aw)</div></div></div><div><div></div><div>AIRMASSEUR® WHIRLPOOL</div></div></div></div>		N/A	N/A		
<div><div><div><div><div></div><div>(mw)</div></div></div><div><div></div><div>MICROSILK® WHIRLPOOL</div></div></div></div>		N/A	N/A		
<div><div><div><div><div></div><div>(ma)</div></div></div><div><div></div><div>MICROSILK® AIRMASSEUR®</div></div></div></div>	Includes 1 MicroSilk delivery port, 48 strategically located air jets; MicroSilk unit; 1hp blower w/ heater. Combines all features provided with both (a) & (m) equipped Standard or Premier baths, respectively.	\$9,450 (2147.00.81.CC)	\$10,670 (2147.00.85.CC)		

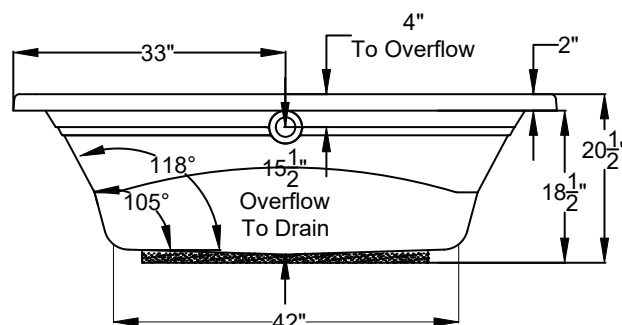
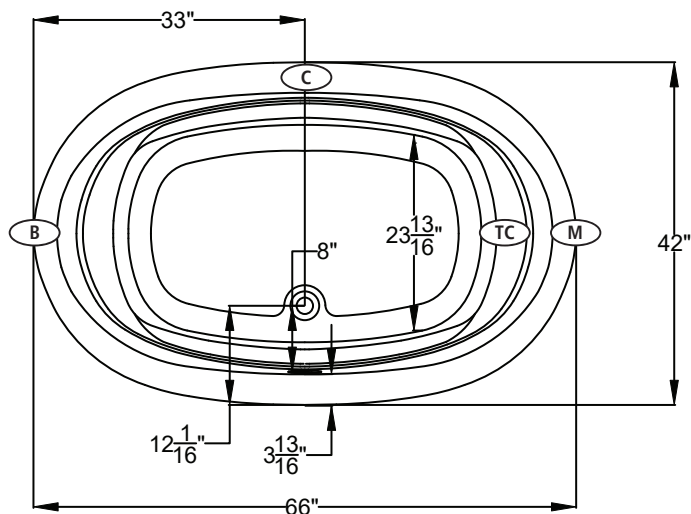

- (C)** Control Location **(B)** Blower Location
(M) MicroSilk[®] Unit Location **(TC)** Thermo Comfort Heating Pad Location
(P) Whirlpool Pump Location

Bath Options

For handle information, see page 127.
For details & additional options, see page 128-130.

GH20 HANDLE - Factory installed. Accepts 1 handle across from overflow.		8709-24-0CC	\$240
JETTED NECK PILLOW - Page 128		8707-50-0CC	N/A
BACKSTACK™ JETS - Page 128		8707-30-001	N/A
BLUETOOTH SOUND IMMERSION SYSTEM - Page 128		8724-01-000	\$835
WATER LEVEL SENSOR - Page 128		8724-02-000	\$1,030
THERMO COMFORT - Page 129 (S) (m) (ma)		8706-04-XXX	\$840
MICROSILK SHOWER WAND - Page 129	Polished Chrome	8705-55-091	\$505
	Optional Finishes	DDK-XX	\$275
DESIGNER OVERFLOW DRAIN KITS - For finish options, see Page 129.		DDK-PC	\$160
		DDK-XX	\$275